



**BUHLMANN**  
TUBE SOLUTIONS

**Stocklist – ASTM Fittings**  
Vorratsliste – ASTM Fittings

**we know how**

Power | Chemical | Engineering | Shipyards | Oil & Gas | Projects



**BUHLMANN**  
TUBE SOLUTIONS

# we know how

## ASTM Fittings

ASTM Fittings

### Contents

Inhalt

<b>90° Elbows LR</b>	<b>Page</b>	<b>6</b>
90° Bogen LR	Seite	6
<b>45° Elbows LR</b>	<b>Page</b>	<b>10</b>
45° Bogen LR	Seite	10
<b>90° Elbows SR</b>	<b>Page</b>	<b>12</b>
90° Bogen SR	Seite	12
<b>Tees</b>	<b>Page</b>	<b>14</b>
T-Stücke	Seite	14
<b>Concentric Reducers</b>	<b>Page</b>	<b>20</b>
Konzentrische Reduzierstücke	Seite	20
<b>Eccentric Reducers</b>	<b>Page</b>	<b>26</b>
Exzentrische Reduzierstücke	Seite	26
<b>Caps</b>	<b>Page</b>	<b>30</b>
Kappen	Seite	30
<b>Technical Data</b>	<b>Page</b>	<b>32</b>
Technische Daten	Seite	32

**Stocklist Contains Fittings in the Following Grades**  
Vorratsliste enthält Fittings in folgenden Qualitäten

**Seamless fittings,  
with bevelled ends to ANSI B 16.25  
certificates according to EN 10204/3.1**

**to ASME / ANSI B 16.9**  
– Elbows L.R.  
– Tees  
– Concentric Reducers  
– Eccentric Reducers  
– Caps

**to ASME / ANSI B 16.9 / B 16.28**  
– Elbows S.R.

**Materials**  
– ASTM / ASME SA 234 Grade WPB  
– ASTM / ASME SA 234 Grade WP11  
– ASTM / ASME SA 234 Grade WP22  
– ASTM / ASME SA 234 Grade WPL6

**Nahtlose Fittings,  
mit Fase nach ANSI B 16.25  
Werksabnahmezeugnis nach EN 10204/3.1**

**nach ASME / ANSI B 16.9**  
– Rohrbogen L.R.  
– T-Stücke  
– Konzentrische Reduzierstücke  
– Exzentrische Reduzierstücke  
– Kappen

**nach ASME / ANSI B 16.9 / B 16.28**  
– Rohrbogen S.R.

**aus Material**  
– ASTM / ASME SA 234 Grade WPB  
– ASTM / ASME SA 234 Grade WP11  
– ASTM / ASME SA 234 Grade WP22  
– ASTM / ASME SA 234 Grade WPL6

**we know how**

---

**ASTM Fittings**  
ASTM Fittings

# 90° Elbows LR

## 90° Bogen LR

Nominal Size Abmessung		kilos/pc. kg/St.	OD AD D mm	Wall Wand mm	Dimensions Baumaße mm	SAVA 234 WPB	SAVA 420 WPL6	SAVA 234 WP11	SAVA 234 WP22	SAVA 234 WP5	SAVA 234 WP91
1/2"	STD	0,080	21,3	2,770	A = 38 K = 48	●	●	●			
	XS	0,100		3,730		●	●	●			
	SCH 160	0,120		4,780		●	●	●			
3/4"	STD	0,080	26,7	2,870	A = 38 K = 51	●	●	●			
	XS	0,100		3,910		●	●	●			
	SCH 160	0,140		5,560		●	●	●			
1"	STD	0,150	33,4	3,380	A = 38 O = 76 K = 56	●	●	●	●	●	
	XS	0,200		4,550		●	●	●	●	●	
	SCH 160	0,260		6,350		●	●	●	●	●	
	XXS	0,380		9,090		●			●		
1 1/4"	STD	0,260	42,2	3,560	A = 48 K = 70	●	●	●	●	●	
	XS	0,340		4,850		●	●	●	●	●	
	SCH 160	0,380		6,350		●		●	●		
	XXS	0,580		9,700					●		
1 1/2"	STD	0,380	48,3	3,680	A = 57 K = 83	●	●	●	●	●	
	XS	0,480		5,080		●	●	●	●	●	
	SCH 160	0,640		7,140		●	●	●	●		
	XXS	0,900		10,160		●			●		
2"	STD	0,680	60,3	3,910	A = 76 K = 106	●	●	●	●	●	
	XS	0,910		5,540		●	●	●	●	●	
	SCH 160	1,320		8,740		●	●	●	●	●	
	XXS	1,680		11,070		●			●		
2 1/2"	STD	1,330	73,0	5,160	A = 95 K = 132	●	●	●	●		
	XS	1,730		7,010		●	●	●	●		
	SCH 160	2,350		9,520		●		●	●		
	XXS	3,060		14,020					●		
3"	STD	2,080	88,9	5,490	A = 114 O = 229 K = 159	●	●	●	●	●	●
	XS	2,780		7,620		●	●	●	●	●	●
	SCH 160	3,750		11,130		●		●	●	●	●
	XXS	5,180		15,240		●			●		
4"	STD	3,950	114,3	6,020	A = 152 K = 210	●	●	●	●	●	●
	XS	5,400		8,560		●	●	●	●	●	
	SCH 120	6,800		11,130		●					
	SCH 160	9,000		13,590		●	●	●	●	●	
	XXS	10,300		17,120		●			●		

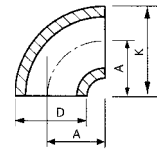

## 90° Elbows LR

### 90° Bogen LR

Nominal Size Abmessung		kilos/pc. kg/St.	OD AD D mm	Wall Wand mm	Dimensions Baumaße mm	SMA-234 WPB	SMA 420 WPL6	SMA 234 WP11	SMA 234 WP22	SMA-234 WP5	SMA 234 WP91	
5"	STD	6,670	141,3	6,550	A = 190 K = 262	●	●	●	●	●		
	XS	9,340		9,520		●	●	●	●			
	SCH 120	12,000		12,700			●					
	SCH 160	14,700		15,880		●		●				
	XXS	17,200		19,050		●			●			
6"	STD	10,400	168,3	7,110	A = 229 K = 313	●	●	●	●	●		
	XS	15,500		10,970		●	●	●	●	●		
	SCH 120	19,500		14,270		●	●					
	SCH 160	26,000		18,260		●	●	●	●	●	●	
	XXS	29,900		21,950		●			●			
		32,000		25,400		●						
8"	SCH 20	16,200	219,1	6,350	A = 305 K = 414	●						
	STD	20,900		8,180		●	●	●	●	●		
	SCH 60	26,300		10,310		●						
	XS	31,300		12,700		●	●	●	●	●		
	SCH 100	38,200		15,090		●						
	SCH 120	45,400		18,260		●						
	XXS	54,400		22,220		●						
	SCH 160	55,900		23,010		●		●	●			
		59,000		25,400		●						
10"	SCH 20	25,300	273,0	6,350	A = 381 K = 518	●						
	STD	37,000		9,270		●	●	●	●	●		
	XS	49,400		12,700		●	●	●	●	●		
	SCH 80	61,300		15,090		●		●	●			
	SCH 100	68,600		18,260		●		●				
	SCH 120	83,500		21,440		●	●				●	
	XXS	92,800		25,400					●		●	
	SCH 160	103,000		28,580		●		●	●			
12"	SCH 20	35,900	323,8	6,350	A = 457 K = 619	●						
	STD	54,000		9,530		●	●	●	●	●		
	SCH 40	58,150		10,310		●						
	XS	71,200		12,700		●	●	●	●	●		
	SCH 60	82,260		14,270		●						
	SCH 80	94,700		17,480		●		●	●			
	SCH 100	115,000		21,440		●		●				
	XXS	134,000		25,400		●						
	SCH 160	171,000		33,320		●		●				

# 90° Elbows LR

## 90° Bogen LR

Nominal Size Abmessung		kilos/pc. kg/St.	OD AD D mm	Wall Wand mm	Dimensions Baumaße mm	SAVA 234 WPB	SAVA 420 WPL6	SAVA 234 WP11	SAVA 234 WP22	SAVA 234 WP5	SAVA 234 WP91	
14"	STD	69,900	355,6	9,520	A = 457 K = 619	●	●	●				
	SCH 40	83,060		11,130		●						
	XS	91,600		12,700		●	●	●	●			
	SCH 80	132,000		19,050		●						
	SCH 100	171,230		23,830		●						
	SCH 120	188,000		27,790		●						
	SCH 160	247,700		35,710						●		
16"	STD	91,200	406,4	9,520	A = 610 K = 813	●	●	●				
	XS	120,000		12,700		●	●	●	●			
	SCH 60	153,000		16,660		●					●	
	SCH 80	195,000		21,440		●			●			
	SCH 100	235,000		26,190		●			●			
	SCH 120	274,000		30,960		●			●			
	SCH 140	334,830		36,530						●		
18"	STD	116,000	457,2	9,520	A = 686 K = 914	●						
	XS	153,000		12,700		●		●				
	SCH 40	176,210		14,270		●						
	SCH 60	232,700		19,050		●					●	
	SCH 80	273,000		23,830		●			●	●		
	SCH 100	350,640		29,360		●						
	SCH 120	382,500		34,930				●				
20"	STD	144,000	508,0	9,520	A = 762 K = 1016	●		●				
	XS	190,000		12,700		●		●	●			
	SCH 60	311,020		20,620					●			
	SCH 80	372,000		26,190		●				●		
22"	STD	174,600	558,8	9,520	A = 838 K = 1118	●						
	XS	230,400		12,700		●						
	SCH 100	623,360		34,920						●		
24"	STD	208,000	609,6	9,520	A = 914 K = 1219	●		●				
	XS	275,000		12,700		●		●				
	SCH 30	298,000		14,270		●						
	SCH 60	451,000		24,610					●		●	
	SCH 80	510,000		30,960		●				●		

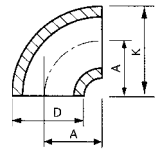

# 45° Elbows LR

## 45° Bogen LR

Nominal Size Abmessung	kilos/pc. kg/St.	OD AD D mm	Wall Wand mm	Dimensions Baumaße mm	SAVA 234 WPB	SAVA 420 WPL6	SAVA 234 WP11	SAVA 234 WP22	SAVA 234 WP5
1/2"	STD	0,040	21,3	2,770	A = 38 K = 48	●			
	XS	0,050		3,730		●			
	SCH 160	0,050		4,780		●			
3/4"	STD	0,050	26,7	2,870	A = 38 K = 51	●			
	XS	0,060		3,910		●			
	SCH 160	0,060		5,560		●			
1"	STD	0,110	33,4	3,380	A = 38 K = 56	●			
	XS	0,140		4,550		●			
	SCH 160	0,150		6,350		●	●		
	XXS	0,170		9,090		●			●
1 1/4"	STD	0,170	42,2	3,560	A = 48 K = 70	●			
	XS	0,220		4,850		●			
	SCH 160	0,220		6,350		●			
1 1/2"	STD	0,230	48,3	3,680	A = 57 K = 83	●	●		
	XS	0,290		5,080		●			
	SCH 160	0,340		7,140		●			
	XXS	0,450		10,160		●			
2"	STD	0,370	60,3	3,910	A = 76 K = 106	●	●	●	
	XS	0,490		5,540		●	●	●	
	SCH 160	0,700		8,740		●			
2 1/2"	STD	0,740	73,0	5,160	A = 95 K = 132	●			
	XS	0,950		7,010		●			
	SCH 160	1,170		9,520		●			
3"	STD	1,100	88,9	5,490	A = 114 K = 159	●	●	●	
	XS	1,470		7,620		●	●	●	
	SCH 160	2,010		11,130		●			
4"	STD	1,950	114,3	6,020	A = 152 K = 210	●	●	●	
	XS	2,660		8,560		●	●	●	
	SCH 120	3,560		11,130		●			
	SCH 160	4,210		13,590		●			
5"	STD	3,310	141,3	6,550	A = 190 K = 262	●			
	XS	4,630		9,520		●			
6"	STD	5,130	168,3	7,110	A = 229 K = 313	●	●		
	XS	7,570		10,970		●	●	●	
	SCH 120	10,210		14,270		●			

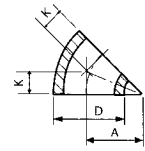

# 45° Elbows LR

## 45° Bogen LR

Nominal Size Abmessung	kilos/pc. kg/St.	OD AD D mm	Wall Wand mm	Dimensions Baumaße mm	SAVA 234 WPB	SAVA 420 WPL6	SAVA 234 WP11	SAVA 234 WP22	SAVA 234 WP5	
8" SCH 20	8,370	219,1	6,350	A = 305 K = 414	●					
	STD		10,300		8,180	●	●			
	SCH 60		13,330		10,310	●				
	XS		15,400		12,700	●	●	●		
	SCH 100		19,100		15,090	●				
	SCH 120		22,730		18,260	●				
10" STD	18,300	273,0	9,270	A = 381 K = 518	●		●			
	XS		24,400		12,700	●		●		
	SCH 80		30,160		15,090	●				
	SCH 120		41,770		21,440	●				
12" STD	27,000	323,8	9,530	A = 457 K = 619	●					
	SCH 40		30,040		10,310	●				
	XS		35,500		12,700	●		●		
14" STD	34,700	355,6	9,520	A = 457 K = 619	●					
	XS		45,400		12,700	●				
	SCH 80		69,340		19,050	●				
16" STD	45,400	406,4	9,520	A = 610 K = 813	●					
	XS		59,900		12,700	●				
	SCH 60		80,650		16,660	●				●
	SCH 100		123,430		26,190			●		
18" STD	58,100	457,2	9,520	A = 686 K = 914	●					
	XS		76,200		12,700	●				
	SCH 80		143,790		23,830	●				
20" STD	71,700	508,0	9,520	A = 762 K = 1016	●					
	XS		94,300		12,700	●				
24" STD	103,900	609,6	9,520	A = 914 K = 1219	●					
	XS		137,000		12,700	●				
	SCH 30		157,680		14,270	●				

# 90° Elbows SR

## 90° Bogen SR

Nominal Size Abmessung	kilos/pc. kg/St.	OD AD D mm	Wall Wand mm	Dimensions Baumaße mm	SWA 234 WPB	SWA 420 WPL6
1" STD	0,150	33,4	3,380	A = 25 K = 41	●	
	0,200		4,550		●	●
	0,260		6,350		●	
1 1/4" STD	0,260	42,2	3,560	A = 32 K = 52	●	
	0,340		4,850		●	
	0,380		6,350		●	
1 1/2" STD	0,380	48,3	3,680	A = 38 K = 62	●	
	0,480		5,080		●	●
	0,640		7,140		●	
2" STD	0,680	60,3	3,910	A = 51 K = 81	●	
	0,910		5,540		●	●
	1,320		8,740		●	
2 1/2" STD	1,330	73,0	5,160	A = 64 K = 100	●	
	1,730		7,010		●	●
	2,350		9,520		●	
3" STD	2,080	88,9	5,490	A = 76 K = 121	●	●
	2,780		7,620		●	●
	3,750		11,130		●	
4" STD	3,950	114,3	6,020	A = 102 K = 159	●	
	5,400		8,560		●	●
	5,620		13,490		●	
5" STD	6,670	141,3	6,550	A = 127 K = 197	●	
	9,340		9,520		●	
6" STD	10,400	168,3	7,110	A = 152 K = 237	●	
	15,500		10,970		●	●
	24,200		18,260		●	
8" STD	20,900	219,1	8,180	A = 203 K = 313	●	
	31,300		12,700		●	
	55,900		23,010		●	
10" STD	37,000	273,1	9,270	A = 254 K = 391	●	●
	49,400		12,700		●	
12" STD	54,000	323,9	9,530	A = 305 K = 467	●	
	71,200		12,700		●	

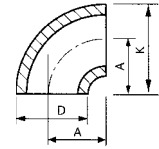

## 90° Elbows SR

### 90° Bogen SR

Nominal Size Abmessung	kilos/pc. kg/St.	OD AD D mm	Wall Wand mm	Dimensions Baumaße mm	SMA 234 WPB	SMA 420 WPL6	
14" STD	69,900	355,6	9,520	A = 356 K = 533	●		
	SCH 40		83,060		11,130		●
	XS		91,600		12,700	●	●
16" STD	91,200	406,4	9,520	A = 610 K = 813	●		
	XS		120,000		12,700	●	
18" STD	116,000	457,2	9,520	A = 457 K = 686	●		
	XS		153,000		12,700	●	
	SCH 40		176,210		14,270		●
20" STD	144,000	508,0	9,520	A = 508 K = 762	●		
	XS		190,000		12,700	●	
24" STD	208,000	609,6	9,520	A = 610 K = 914	●		
	XS		275,000		12,700	●	

# Tees

## T-Stücke

Nominal Size Abmessung	kilos/pc. kg/St..	OD D <sub>1</sub> Run AD D <sub>1</sub> Durchgang	Wall s <sub>1</sub> Run Wand s <sub>1</sub> Durchgang	OD D <sub>2</sub> Branch AD D <sub>2</sub> Abzweig	Wall s <sub>2</sub> Branch Wand s <sub>2</sub> Abzweig	Center to End Run Mittenabstand Durchgang A mm	Center to End branch Mittenabstand Abzweig B mm	SAVA 234 WPB	SAVA 420 WPL6	SAVA 234 WP11	SAVA 234 WP22	SAVA 234 WP5	SAVA 234 WP91
		mm	mm	mm	mm	mm	mm						
1/2"	x 1/2" STD	0,110	21,3	2,770	21,3	2,770	25,4	25,4	●	●	●		
	x 1/2" XS	0,140	21,3	3,730	21,3	3,730	25,4	25,4	●	●	●		
	x 1/2" SCH 160	0,300	21,3	4,780	21,3	4,780	25,4	25,4	●	●			
3/4"	x 1/2" STD	0,200	26,7	2,870	21,3	2,770	28,6	28,6	●	●			
	x 1/2" XS	0,200	26,7	3,910	21,3	3,730	28,6	28,6	●	●	●		
	x 3/4" STD	0,170	26,7	2,870	26,7	2,870	28,6	28,6	●	●			
	x 3/4" XS	0,210	26,7	3,910	26,7	3,910	28,6	28,6	●	●	●		
	x 3/4" SCH 160	0,290	26,7	5,560	26,7	5,560	28,6	28,6	●	●	●		
	x 3/4" XXS	0,550	26,7	7,820	26,7	7,820	28,6	28,6		●			
1"	x 1/2" STD	0,290	33,4	3,380	21,3	2,770	38,1	38,1	●				
	x 1/2" XS	0,360	33,4	4,550	21,3	3,730	38,1	38,1	●		●		
	x 1/2" SCH 160	0,470	33,4	6,350	21,3	4,780	38,1	38,1	●				
	x 3/4" STD	0,290	33,4	3,380	26,7	2,870	38,1	38,1	●	●		●	
	x 3/4" XS	0,360	33,4	4,550	26,7	3,910	38,1	38,1	●	●	●	●	
	x 3/4" SCH 160	0,450	33,4	6,350	26,7	5,560	38,1	38,1	●	●			
	x 3/4" XXS	0,650	33,4	9,090	26,7	7,820	38,1	38,1	●				
	x 1" STD	0,290	33,4	3,380	33,4	3,380	38,1	38,1	●	●	●	●	●
	x 1" XS	0,360	33,4	4,550	33,4	4,550	38,1	38,1	●	●	●	●	●
	x 1" SCH 160	0,450	33,4	6,350	33,4	6,350	38,1	38,1	●	●	●	●	●
x 1" XXS	0,650	33,4	9,090	33,4	9,090	38,1	38,1	●	●				
1 1/4"	x 3/4" STD	0,500	42,2	3,560	26,7	2,870	47,6	47,6	●				
	x 3/4" XS	0,630	42,2	4,880	26,7	3,910	47,6	47,6	●				
	x 1" STD	0,530	42,2	3,560	33,4	3,380	47,6	47,6	●			●	
	x 1" XS	0,660	42,2	4,850	33,4	4,550	47,6	47,6	●		●	●	
	x 1" SCH 160	0,800	42,2	6,350	33,4	6,350	47,6	47,6	●				
	x 1 1/4" STD	0,610	42,2	3,560	42,2	3,560	47,6	47,6	●		●	●	●
	x 1 1/4" XS	0,740	42,2	4,850	42,2	4,850	47,6	47,6	●		●	●	●
	x 1 1/4" SCH 160	0,800	42,2	6,350	42,2	6,350	47,6	47,6	●		●	●	
1 1/2"	x 1/2" STD	0,760	48,3	3,680	21,3	2,770	57,2	57,2	●				
	x 1/2" XS	0,920	48,3	5,080	21,3	3,730	57,2	57,2	●				
	x 3/4" STD	0,760	48,3	3,680	26,7	2,870	57,2	57,2	●				
	x 3/4" XS	0,920	48,3	5,080	26,7	3,910	57,2	57,2	●				
	x 3/4" SCH 160	1,790	48,3	7,140	26,7	5,560	57,2	57,2	●				
	x 1" STD	0,760	48,3	3,680	33,4	3,380	57,2	57,2	●	●			●
	x 1" XS	0,920	48,3	5,080	33,4	4,550	57,2	57,2	●	●	●		
	x 1" SCH 160	1,250	48,3	7,140	33,4	6,350	57,2	57,2	●				
	x 1" XXS	2,540	48,3	10,160	33,4	9,090	57,2	57,2	●				
	x 1 1/4" STD	0,760	48,3	3,680	42,2	3,560	57,2	57,2	●		●	●	
	x 1 1/4" XS	0,920	48,3	5,080	42,2	4,850	57,2	57,2	●		●	●	
	x 1 1/4" SCH 160	1,250	48,3	7,140	42,2	6,350	57,2	57,2	●		●	●	
	x 1 1/2" STD	0,760	48,3	3,680	48,3	3,680	57,2	57,2	●		●	●	●
	x 1 1/2" XS	0,920	48,3	5,080	48,3	5,080	57,2	57,2	●		●	●	●
	x 1 1/2" SCH 160	1,250	48,3	7,140	48,3	7,140	57,2	57,2	●		●	●	
x 1 1/2" XXS	2,540	48,3	10,160	48,3	10,160	57,2	57,2	●		●			

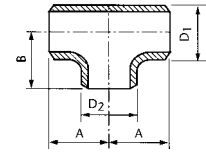

# Tees

## T-Stücke

Nominal Size Abmessung	kilos/pc. kg/St..	OD D <sub>1</sub>	Wall s <sub>1</sub>	OD D <sub>2</sub>	Wall s <sub>2</sub>	Center to	Center to	SAVA 234 WPB	SAVA 420 WPL6	SAVA 234 WP11	SAVA 234 WP22	SAVA 234 WP5	SAVA 234 WP91
		Run AD D <sub>1</sub> Durchgang	Run Wand s <sub>1</sub> Durchgang	Branch AD D <sub>2</sub> Abzweig	Branch Wand s <sub>2</sub> Abzweig	End Run Mittenabstand Durchgang A mm	End branch Mittenabstand Abzweig B mm						
2"	x 3/4" STD	1,100	60,3	3,910	26,7	2,870	63,5	44,5	●				
	x 3/4" XS	1,400	60,3	5,540	26,7	3,910	63,5	44,5	●				
	x 3/4" SCH 160	3,180	60,3	8,740	26,7	5,560	63,5	44,5	●				
	x 1" STD	1,120	60,3	3,910	33,4	3,380	63,5	50,8	●		●	●	
	x 1" XS	1,440	60,3	5,540	33,4	4,550	63,5	50,8	●				
	x 1" SCH 160	1,250	60,3	8,740	33,4	6,350	63,5	50,8	●				
	x 1 1/4" STD	1,160	60,3	3,910	42,2	3,560	63,5	57,2	●				
	x 1 1/4" XS	1,480	60,3	5,540	42,2	4,850	63,5	57,2	●		●		
	x 1 1/2" STD	1,210	60,3	3,910	48,3	3,680	63,5	60,3	●		●	●	
	x 1 1/2" XS	1,540	60,3	5,540	48,3	5,080	63,5	60,3	●		●	●	
	x 1 1/2" SCH 160	2,270	60,3	8,740	48,3	7,140	63,5	60,3	●				
	x 1 1/2" XXS	2,730	60,3	11,070	48,3	10,160	63,5	60,3	●				
	x 2" STD	1,340	60,3	3,910	60,3	3,910	63,5	63,5	●	●	●	●	●
	x 2" XS	1,690	60,3	5,540	60,3	5,540	63,5	63,5	●	●	●	●	●
x 2" SCH 160	2,270	60,3	8,740	60,3	8,740	63,5	63,5	●		●	●	●	
x 2" XXS	2,730	60,3	11,070	60,3	11,070	63,5	63,5	●			●		
2 1/2"	x 1" STD	2,000	73,0	5,160	42,2	3,380	76,2	57,2	●				
	x 1" XS	2,510	73,0	7,010	42,2	4,550	76,2	57,2	●				
	x 1 1/4" STD	2,000	73,0	5,160	42,4	3,560	76,2	63,5	●				
	x 1 1/4" XS	2,510	73,0	7,010	42,2	4,850	76,2	63,5	●				
	x 1 1/2" STD	2,040	73,0	5,160	48,3	3,680	76,2	66,7	●	●			
	x 1 1/2" XS	2,700	73,0	7,010	48,3	5,080	76,2	66,7	●	●			
	x 1 1/2" SCH 160	3,350	73,0	9,520	48,3	7,140	76,2	66,7	●				
	x 1 1/2" XXS	4,490	73,0	14,020	48,3	10,160	76,2	66,7	●				
	x 2" STD	2,080	73,0	5,160	60,3	3,910	76,2	69,9	●		●	●	
	x 2" XS	2,800	73,0	7,010	60,3	5,540	76,2	69,9	●		●	●	
	x 2" SCH 160	3,350	73,0	9,520	60,3	8,740	76,2	69,9	●				
	x 2" XXS	4,490	73,0	14,020	60,3	11,070	76,2	69,9	●				
	x 2 1/2" STD	2,360	73,0	5,160	73,0	5,160	76,2	76,2	●		●	●	
	x 2 1/2" XS	2,920	73,0	7,010	73,0	7,010	76,2	76,2	●		●	●	
x 2 1/2" SCH 160	3,350	73,0	9,520	73,0	9,520	76,2	76,2	●		●	●		
x 2 1/2" XXS	4,490	73,0	14,020	73,0	14,020	76,2	76,2	●					
3"	x 1" STD	2,850	88,9	5,490	33,4	3,380	85,7	66,7	●				
	x 1" XS	3,800	88,9	7,620	33,4	4,550	85,7	66,7	●				
	x 1 1/4" STD	2,920	88,9	5,490	48,3	3,560	85,7	69,9	●				
	x 1 1/4" XS	3,800	88,9	7,620	48,3	4,850	85,7	69,9	●				
	x 1 1/2" STD	2,920	88,9	5,490	48,3	3,680	85,7	73,0	●	●	●	●	
	x 1 1/2" XS	3,800	88,9	7,620	48,3	5,080	85,7	73,0	●	●	●	●	
	x 1 1/2" SCH 160	5,750	88,9	11,130	48,3	7,140	85,7	73,0	●				
	x 1 1/2" XXS	6,300	88,9	15,240	48,3	10,160	85,7	73,0	●				
	x 2" STD	2,950	88,9	5,490	60,3	3,910	85,7	76,2	●	●	●	●	
	x 2" XS	3,790	88,9	7,620	60,3	5,540	85,7	76,2	●	●	●	●	
	x 2" SCH 160	5,500	88,9	11,130	60,3	8,740	85,7	76,2	●				
	x 2" XXS	7,500	88,9	15,240	60,3	11,070	85,7	76,2	●				
	x 2 1/2" STD	3,090	88,9	5,490	73,0	5,160	85,7	82,6	●		●	●	
	x 2 1/2" XS	3,800	88,9	7,620	73,0	7,010	85,7	82,6	●		●	●	

# Tees

## T-Stücke

Nominal Size Abmessung	kilos/pc. kg/St..	OD D <sub>1</sub> Run AD D <sub>1</sub> Durchgang	Wall s <sub>1</sub> Run Wand s <sub>1</sub> Durchgang	OD D <sub>2</sub> Branch AD D <sub>2</sub> Abzweig	Wall s <sub>2</sub> Branch Wand s <sub>2</sub> Abzweig	Center to End Run Mittenabstand Durchgang A mm	Center to End branch Mittenabstand Abzweig B mm	SAVA 234 WPB	SAVA 420 WPL6	SAVA 234 WP11	SAVA 234 WP22	SAVA 234 WP5	SAVA 234 WP91
		mm	mm	mm	mm	mm	mm						
3"	x 2 1/2" SCH 160	5,500	88,9	11,130	73,0	9,520	85,7	82,6	●		●	●	
	x 2 1/2" XXS	7,500	88,9	15,240	73,0	14,020	85,7	82,6	●				
	x 3" STD	3,370	88,9	5,490	88,9	5,490	85,7	85,7	●	●	●		●
	x 3" XS	4,290	88,9	7,620	88,9	7,620	85,7	85,7	●	●	●	●	●
	x 3" SCH 160	5,500	88,9	11,130	88,9	11,130	85,7	85,7	●		●	●	●
	x 3" XXS	7,500	88,9	15,240	88,9	15,240	85,7	85,7	●				
4"	x 1 1/2" STD	4,940	114,3	6,020	48,3	3,680	104,8	85,7	●				
	x 1 1/2" XS	6,530	114,3	8,560	48,3	5,080	104,8	85,7	●				
	x 2" STD	4,990	114,3	6,020	60,3	3,910	104,8	88,9	●	●			
	x 2" XS	6,580	114,3	8,560	60,3	5,540	104,8	88,9	●	●			
	x 2" SCH 160	10,750	114,3	13,490	60,3	8,740	104,8	88,9	●				
	x 2 1/2" STD	5,130	114,3	6,020	73,0	5,160	104,8	95,3	●		●		
	x 2 1/2" XS	6,670	114,3	8,560	73,0	7,010	104,8	95,3	●		●		
	x 3" STD	5,170	114,3	6,020	88,9	5,490	104,8	98,4	●		●		
	x 3" XS	6,800	114,3	8,560	88,9	7,620	104,8	98,4	●			●	
	x 3" SCH 160	15,900	114,3	13,490	88,9	11,130	104,8	98,4	●				
	x 3" XXS	17,000	114,3	17,120	88,9	15,240	104,8	98,4	●				
	x 4" STD	5,720	114,3	6,020	114,3	6,020	104,8	104,8	●	●	●	●	●
	x 4" XS	7,440	114,3	8,560	114,3	8,560	104,8	104,8	●	●	●	●	●
	x 4" SCH 160	15,900	114,3	13,490	114,3	13,490	104,8	104,8	●			●	●
x 4" XXS	17,000	114,3	17,120	114,3	17,120	104,8	104,8	●					
5"	x 2" STD	7,800	141,3	6,550	60,3	3,910	123,8	104,8	●				
	x 2" XS	10,600	141,3	9,520	60,3	5,540	123,8	104,8	●				
	x 2 1/2" STD	7,890	141,3	6,550	73,0	5,160	123,8	108,0	●				
	x 2 1/2" XS	10,700	141,3	9,520	73,0	7,010	123,8	108,0	●				
	x 3" STD	7,980	141,3	6,550	88,9	5,490	123,8	111,1	●				
	x 3" XS	10,750	141,3	9,520	88,9	7,620	123,8	111,1	●				
	x 4" STD	8,210	141,3	6,550	114,3	6,020	123,8	117,5	●		●	●	
	x 4" XS	11,000	141,3	9,520	114,3	8,560	123,8	117,5	●		●	●	
	x 5" STD	8,980	141,3	6,550	141,3	6,550	123,8	123,8	●		●	●	
	x 5" XS	12,000	141,3	9,520	141,3	9,520	123,8	123,8	●		●	●	
	x 5" SCH 160	23,000	141,3	15,880	141,3	15,880	123,8	123,8	●			●	
	x 5" XXS	26,200	141,3	19,050	141,3	19,050	123,8	123,8	●				
6"	x 2 1/2" STD	11,700	168,3	7,110	73,0	5,160	142,9	120,7	●	●			
	x 2 1/2" XS	16,700	168,3	10,970	73,0	7,010	142,9	120,7	●	●			
	x 3" STD	11,700	168,3	7,110	88,9	5,490	142,9	123,8	●	●			●
	x 3" XS	16,700	168,3	10,970	88,9	7,620	142,9	123,8	●	●			●
	x 4" STD	11,900	168,3	7,110	114,3	6,020	142,9	130,2	●		●		●
	x 4" XS	16,900	168,3	10,970	114,3	8,560	142,9	130,2	●				●
	x 5" STD	12,100	168,3	7,110	141,3	6,550	142,9	136,5	●	●	●	●	
	x 5" XS	17,100	168,3	10,970	141,3	9,520	142,9	136,5	●		●	●	
	x 6" STD	13,300	168,3	7,110	168,3	7,110	142,9	142,9	●	●	●	●	●
	x 6" XS	19,100	168,3	10,970	168,3	10,970	142,9	142,9	●	●	●	●	●
	x 6" SCH 120	24,000	168,3	14,270	168,3	14,270	142,9	142,9	●				
	x 6" SCH 160	39,500	168,3	18,260	168,3	18,260	142,9	142,9	●			●	

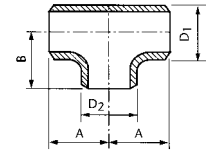

# Tees

## T-Stücke

Nominal Size Abmessung			kilos/pc. kg/St..	OD D <sub>1</sub> Run AD D <sub>1</sub> Durchgang	Wall s <sub>1</sub> Run Wand s <sub>1</sub> Durchgang	OD D <sub>2</sub> Branch AD D <sub>2</sub> Abzweig	Wall s <sub>2</sub> Branch Wand s <sub>2</sub> Abzweig	Center to End Run Mittenabstand Durchgang A mm	Center to End branch Mittenabstand Abzweig B mm	SAVA 234 WPB	SAVA 420 WPL6	SAVA 234 WP11	SAVA 234 WP22	SAVA 234 WP5	SAVA 234 WP91
				mm	mm	mm	mm	mm	mm						
6"	x 6"	XXS	38,000	168,3	21,950	168,3	21,950	142,9	142,9	●					
8"	x 3"	STD	21,000	219,1	8,180	88,9	5,490	177,8	152,4	●	●				
	x 3"	XS	31,300	219,1	12,700	88,9	7,620	177,8	152,4	●					
	x 4"	STD	21,700	219,1	8,180	114,3	6,020	177,8	155,6	●		●			
	x 4"	XS	33,000	219,1	12,700	114,3	8,560	177,8	155,6	●					
	x 5"	STD	21,800	219,1	8,180	141,3	6,550	177,8	161,9	●					
	x 5"	XS	31,500	219,1	12,700	141,3	9,520	177,8	161,9	●					
	x 6"	STD	22,100	219,1	8,180	168,3	7,110	177,8	168,3	●	●	●			●
	x 6"	XS	31,900	219,1	12,700	168,3	10,970	177,8	168,3	●	●	●	●		
	x 8"	SCH 20	23,000	219,1	6,350	219,1	6,350	177,8	177,8	●					
	x 8"	STD	24,400	219,1	8,180	219,1	8,180	177,8	177,8	●	●	●			●
	x 8"	SCH 60	31,750	219,1	10,310	219,1	10,310	177,8	177,8	●					
	x 8"	XS	34,700	219,1	12,700	219,1	12,700	177,8	177,8	●	●	●	●	●	
	x 8"	SCH 120	49,500	219,1	18,260	219,1	18,260	177,8	177,8	●					
x 8"	SCH 160	52,000	219,1	23,010	219,1	23,010	177,8	177,8	●			●			
10"	x 4"	STD	36,900	273,0	9,270	114,3	6,020	215,9	184,2	●		●			
	x 4"	XS	48,100	273,0	12,700	114,3	8,560	215,9	184,2	●				●	
	x 5"	STD	36,900	273,0	9,270	141,3	6,550	215,9	190,5	●					
	x 5"	XS	48,100	273,0	12,700	141,3	9,520	215,9	190,5	●					
	x 6"	STD	37,100	273,0	9,270	168,3	7,110	215,9	193,7	●		●			
	x 6"	XS	49,000	273,0	12,700	168,3	10,970	215,9	193,7	●					
	x 6"	SCH 120	81,700	273,0	21,440	168,3	14,270	215,9	193,7	●					●
	x 8"	STD	37,600	273,0	9,270	219,1	8,180	215,9	203,2	●					
	x 8"	XS	49,400	273,0	12,700	219,1	12,700	215,9	203,2	●			●		
	x 8"	SCH 80	65,800	273,0	15,090	219,1	12,700	215,9	203,2	●					
	x 10"	STD	41,400	273,0	9,270	273,0	9,270	215,9	215,9	●	●	●			●
	x 10"	XS	53,500	273,0	12,700	273,0	12,700	215,9	215,9	●	●	●	●	●	
	x 10"	SCH 80	73,100	273,0	15,090	273,0	15,090	215,9	215,9	●			●		
x 10"	SCH 120	93,000	273,0	21,440	273,0	21,440	215,9	215,9	●						
12"	x 5"	STD	53,200	323,8	9,520	141,3	6,550	254,0	215,9	●					
	x 5"	XS	68,500	323,8	12,700	141,3	9,520	254,0	215,9	●					
	x 6"	STD	53,100	323,8	9,520	168,3	7,110	254,0	219,1	●					
	x 6"	SCH 40	67,200	323,8	10,310	168,3	7,110	254,0	219,1	●					●
	x 6"	XS	68,500	323,8	12,700	168,3	10,970	254,0	219,1	●					
	x 6"	SCH 160	140,250	323,8	33,320	168,3	18,260	254,0	219,1	●			●		
	x 8"	STD	53,500	323,8	9,520	219,1	8,180	254,0	228,6	●					
	x 8"	XS	69,400	323,8	12,700	219,1	12,700	254,0	228,6	●		●			
	x 8"	SCH 140	140,250	323,8	28,580	219,1	20,620	254,0	228,6	●			●		
	x 8"	SCH 160	159,000	323,8	33,320	219,1	23,010	254,0	228,6	●					
	x 10"	STD	54,900	323,8	9,520	273,0	9,270	254,0	241,3	●					
	x 10"	SCH 40	70,500	323,8	10,310	273,0	9,270	254,0	241,3	●					●
	x 10"	XS	70,300	323,8	12,700	273,0	12,700	254,0	241,3	●	●				
	x 12"	STD	59,900	323,8	9,520	323,8	9,520	254,0	254,0	●					●
	x 12"	SCH 40	65,000	323,8	10,310	323,8	10,310	254,0	254,0	●					●
x 12"	XS	75,700	323,8	12,700	323,8	12,700	254,0	254,0	●			●	●		

# Tees

## T-Stücke

Nominal Size Abmessung			kilos/pc. kg/St..	OD D <sub>1</sub> Run AD D <sub>1</sub> Durchgang	Wall s <sub>1</sub> Run Wand s <sub>1</sub> Durchgang	OD D <sub>2</sub> Branch AD D <sub>2</sub> Abzweig	Wall s <sub>2</sub> Branch Wand s <sub>2</sub> Abzweig	Center to End Run Mittenabstand Durchgang A mm	Center to End branch Mittenabstand Abzweig B mm	SAVA 234 WPB	SAVA 420 WPL6	SAVA 234 WP11	SAVA 234 WP22	SAVA 234 WP5	SAVA 234 WP91
				mm	mm	mm	mm	mm	mm						
12"	x 12"	SCH 60	95,000	323,8	14,270	323,8	14,270	254,0	254,0	●					
	x 12"	SCH 80	115,000	323,8	17,480	323,8	17,480	254,0	254,0	●			●		
14"	x 6"	STD	64,400	355,6	9,520	168,3	7,110	279,4	238,1	●					
	x 6"	XS	83,000	355,6	12,700	168,3	10,970	279,4	238,1	●					
	x 8"	STD	64,900	355,6	9,520	219,1	8,180	279,4	247,7	●					
	x 8"	XS	83,500	355,6	12,700	219,1	12,700	279,4	247,7	●					
	x 10"	STD	65,300	355,6	9,520	273,0	9,270	279,4	257,2	●					
	x 10"	XS	83,900	355,6	12,700	273,0	12,700	279,4	257,2	●					
	x 12"	STD	66,700	355,6	9,520	323,8	9,520	279,4	269,9	●					
	x 12"	XS	85,700	355,6	12,700	323,8	12,700	279,4	269,9	●					
	x 14"	STD	72,100	355,6	9,520	355,6	9,520	279,4	279,4	●					
	x 14"	XS	115,000	355,6	12,700	355,6	12,700	279,4	279,4	●					
x 14"	SCH 80	165,000	355,6	19,050	355,6	19,050	279,4	279,4	●						
16"	x 6"	STD	79,800	406,4	9,520	168,3	7,110	304,8	263,5	●					
	x 6"	XS	101,200	406,4	12,700	168,3	10,970	304,8	263,5	●					
	x 8"	STD	84,000	406,4	9,520	219,1	8,180	304,8	273,1	●					
	x 8"	XS	84,000	406,4	12,700	219,1	12,700	304,8	273,1	●					
	x 10"	STD	88,500	406,4	9,520	273,0	9,270	304,8	282,6	●					
	x 10"	XS	111,000	406,4	12,700	273,0	12,700	304,8	282,6	●					
	x 12"	STD	92,500	406,4	9,520	323,8	9,520	304,8	295,3	●		●			
	x 12"	XS	111,000	406,4	12,700	323,8	12,700	304,8	295,3	●				●	
	x 12"	SCH 140	340,000	406,4	36,530	323,8	28,580	304,8	295,3	●			●		
	x 14"	STD	95,000	406,4	9,520	355,6	9,520	304,8	304,8	●		●			
	x 14"	XS	118,000	406,4	12,700	355,6	12,700	304,8	304,8	●					
	x 16"	STD	99,300	406,4	9,520	406,4	9,520	304,8	304,8	●		●			
	x 16"	XS	122,900	406,4	12,700	406,4	12,700	304,8	304,8	●		●			
	x 16"	SCH 60	206,500	406,4	16,660	406,4	16,660	304,8	304,8	●				●	
x 16"	SCH 80	249,000	406,4	21,440	406,4	21,440	304,8	304,8	●						
x 16"	SCH 140	385,000	406,4	36,530	406,4	36,530	304,8	304,8	●			●			
18"	x 8"	STD	104,800	457,2	9,520	219,1	8,180	342,9	298,5						
	x 8"	XS	133,400	457,2	12,700	219,1	12,700	342,9	298,5						
	x 10"	STD	110,700	457,2	9,520	273,0	9,270	342,9	308,0	●					
	x 10"	XS	139,300	457,2	12,700	273,0	12,700	342,9	308,0						
	x 12"	STD	115,200	457,2	9,520	323,8	9,520	342,9	320,7	●					
	x 12"	XS	145,100	457,2	12,700	323,8	12,700	342,9	320,7					●	
	x 14"	STD	118,800	457,2	9,520	355,6	9,520	342,9	330,2	●					
	x 14"	XS	152,400	457,2	12,700	355,6	12,700	342,9	330,2	●					
	x 16"	STD	122,000	457,2	9,520	406,4	9,520	342,9	330,2	●					
	x 16"	XS	152,400	457,2	12,700	406,4	12,700	342,9	330,2	●					
	x 16"	SCH 40	237,450	457,2	14,270	406,4	12,700	342,9	330,2	●					
	x 16"	SCH 60	256,500	457,2	19,050	406,4	16,660	342,9	330,2	●					
	x 18"	STD	128,000	457,2	9,520	457,2	9,520	342,9	342,9	●					
	x 18"	XS	159,000	457,2	12,700	457,2	12,700	342,9	342,9	●					
	x 18"	SCH 60	277,000	457,2	19,050	457,2	19,050	342,9	342,9					●	
	x 18"	SCH 80	322,000	457,2	23,830	457,2	23,830	342,9	342,9	●					

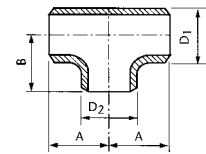

# Tees

## T-Stücke

Nominal Size Abmessung	kilos/pc. kg/St..	OD D <sub>1</sub> Run AD D <sub>1</sub> Durchgang	Wall s <sub>1</sub> Run Wand s <sub>1</sub> Durchgang	OD D <sub>2</sub> Branch AD D <sub>2</sub> Abzweig	Wall s <sub>2</sub> Branch Wand s <sub>2</sub> Abzweig	Center to End Run Mittenabstand Durchgang A	Center to End branch Mittenabstand Abzweig B	SAVA 234 WPB	SAVA 420 WPL6	SAVA 234 WP11	SAVA 234 WP22	SAVA 234 WP5	SAVA 234 WP91
		mm	mm	mm	mm	mm	mm						
20"	x 8" STD	127,900	508,0	9,520	219,1	8,180	381,0	323,9	●				
	x 8" XS	163,700	508,0	12,700	219,1	12,700	381,0	323,9		●			
	x 10" STD	133,800	508,0	9,520	273,0	9,270	381,0	333,4			●		
	x 10" XS	170,600	508,0	12,700	273,0	12,700	381,0	333,4				●	
	x 10" SCH 80	298,250	508,0	26,190	273,0	15,090	381,0	346,1	●				
	x 10" SCH 100	420,000	508,0	32,540	273,0	18,260	381,0	346,1			●		
	x 12" STD	168,300	508,0	9,520	323,8	9,520	381,0	346,1	●				
	x 12" XS	176,900	508,0	12,700	323,8	12,700	381,0	346,1	●				
	x 12" SCH 80	319,150	508,0	26,190	323,8	17,480	381,0	355,6	●				
	x 14" STD	143,300	508,0	9,520	355,6	9,520	381,0	355,6	●				
	x 14" XS	181,000	508,0	12,700	355,6	12,700	381,0	355,6	●				
	x 14" SCH 80	319,150	508,0	26,190	355,6	19,050	381,0	355,6	●				
	x 16" STD	168,000	508,0	9,520	406,4	9,520	381,0	355,6	●				
	x 16" XS	187,000	508,0	12,700	406,4	12,700	381,0	355,6	●		●		
	x 16" SCH 80	350,500	508,0	26,190	406,4	21,440	381,0	355,6	●				
	x 18" STD	168,000	508,0	9,520	457,2	9,520	381,0	368,3	●				
	x 18" XS	193,700	508,0	12,700	457,2	12,700	381,0	368,3	●				
	x 18" SCH 80	405,420	508,0	26,190	457,2	23,830	381,0	368,3	●				
	x 20" STD	160,600	508,0	9,520	508,0	9,520	381,0	381,0	●				
	x 20" XS	200,000	508,0	12,700	508,0	12,700	381,0	381,0	●		●		
x 20" SCH 80	459,000	508,0	26,190	508,0	26,190	381,0	381,0	●					
22"	x 16" XS	225,400	558,8	12,700	406,4	12,700	419,0	381,0			●		
	x 22" STD	198,200	558,8	9,520	558,8	9,520	419,0	419,0	●				
	x 22" XS	248,600	558,8	12,700	558,8	12,700	419,0	419,0	●				
24"	x 10" STD	178,700	609,6	9,520	273,0	9,270	431,8	384,2					
	x 10" XS	227,700	609,6	12,700	273,0	12,700	431,8	384,2					
	x 10" SCH 40	367,800	609,6	17,480	273,0	9,270	431,8	384,2	●				
	x 10" SCH 80	451,960	609,6	30,960	273,0	15,090	431,8	384,2			●		
	x 12" STD	185,500	609,6	9,520	323,8	9,520	431,8	396,9	●				
	x 12" XS	235,000	609,6	12,700	323,8	12,700	431,8	396,9	●				
	x 14" STD	190,100	609,6	9,520	355,6	9,520	431,8	406,4	●				
	x 14" XS	240,000	609,6	12,700	355,6	12,700	431,8	406,4	●				
	x 16" STD	196,400	609,6	9,520	406,4	9,520	431,8	406,4	●				
	x 16" XS	246,800	609,6	12,700	406,4	12,700	431,8	406,4	●				
	x 18" STD	205,500	609,6	9,520	457,2	9,520	431,8	419,1	●				
	x 18" XS	255,800	609,6	12,700	457,2	12,700	431,8	419,1	●				
	x 18" SCH 80	533,250	609,6	30,960	457,2	23,830	431,8	419,1				●	
	x 20" STD	206,000	609,6	9,520	508,0	9,520	431,8	431,8	●				
	x 20" XS	260,800	609,6	12,700	508,0	12,700	431,8	431,8	●				
	x 20" SCH 80	606,100	609,6	30,960	508,0	26,190	431,8	431,8	●				
	x 24" STD	223,600	609,6	9,520	609,6	9,520	431,8	431,8	●				
	x 24" XS	275,000	609,6	12,700	609,6	12,700	431,8	431,8	●				
	x 24" SCH 30	373,000	609,6	14,270	609,6	14,270	431,8	431,8	●				
	x 24" SCH 80	748,000	609,6	30,960	609,6	30,960	431,8	431,8	●				

## Concentric Reducers

### Konzentrische Reduzierstücke

Nominal Size Abmessung			kilos/pc. kg/St.	OD D <sub>1</sub> AD D <sub>1</sub> mm	Wall s <sub>1</sub> Wand s <sub>1</sub> mm	OD D <sub>2</sub> AD D <sub>2</sub> mm	Wall s <sub>2</sub> Wand s <sub>2</sub> mm	Length Bauhöhe L mm	SAVA 234 WPB	SAVA 420 WPL6	SAVA 234 WP11	SAVA 234 WP22	SAVA 234 WP5
1/2"	x 3/8"	STD	0,08	21,3	2,77	17,1	2,31	38,1	●				
	x 3/8"	STD	0,08	21,3	2,77	17,1	2,31	38,1	●				
3/4"	x 3/8"	STD	0,08	26,7	2,87	17,1	2,31	38,1	●				
	x 1/2"	STD	0,09	26,7	2,87	21,3	2,77	38,1	●				
	x 1/2"	XS	0,12	26,7	3,91	21,3	3,73	38,1	●				
1"	x 1/2"	STD	0,14	33,4	3,38	21,3	2,77	50,8	●	●	●	●	●
	x 1/2"	XS	0,16	33,4	4,55	21,3	3,73	50,8	●	●	●	●	●
	x 1/2"	SCH 160	0,21	33,4	6,35	21,3	4,78	50,8	●	●			
	x 3/4"	STD	0,14	33,4	3,38	26,7	2,87	50,8	●	●	●	●	●
	x 3/4"	XS	0,17	33,4	4,55	26,7	3,91	50,8	●	●	●	●	●
	x 3/4"	SCH 160	0,21	33,4	6,35	26,7	5,56	50,8	●	●			
1 1/4"	x 1/2"	STD	0,17	42,2	3,56	26,7	2,77	50,8	●				
	x 1/2"	XS	0,23	42,2	4,85	26,7	3,73	50,8	●				
	x 3/4"	STD	0,20	42,2	3,56	26,7	2,87	50,8	●		●	●	
	x 3/4"	XS	0,23	42,2	4,88	26,7	3,91	50,8	●		●	●	
	x 3/4"	SCH 160	0,29	42,2	6,35	26,7	5,53	50,8	●				
	x 1"	STD	0,20	42,2	3,56	33,4	3,38	50,8	●		●	●	
	x 1"	XS	0,24	42,2	4,85	33,4	4,55	50,8	●		●	●	
	x 1"	SCH 160	0,29	42,2	6,35	33,4	6,35	50,8	●				
1 1/2"	x 1/2"	STD	0,20	48,3	3,68	21,3	2,77	63,5	●				
	x 1/2"	XS	0,28	48,3	5,08	21,3	3,73	63,5	●				
	x 1/2"	SCH 160	0,46	48,3	7,14	21,3	4,74	63,5	●				
	x 3/4"	STD	0,22	48,3	3,68	26,7	2,87	63,5	●				
	x 3/4"	XS	0,27	48,3	5,08	26,7	3,91	63,5	●				
	x 1"	STD	0,24	48,3	3,68	33,4	3,38	63,5	●		●	●	
	x 1"	XS	0,31	48,3	5,08	33,4	4,55	63,5	●		●	●	
	x 1"	SCH 160	0,46	48,3	7,14	33,4	7,14	63,5	●				
	x 1 1/4"	STD	0,26	48,3	3,68	42,2	3,56	63,5	●		●	●	
	x 1 1/4"	XS	0,33	48,3	5,08	42,2	4,85	63,5	●		●	●	
	x 1 1/4"	SCH 160	0,46	48,3	7,14	42,2	6,35	63,5	●				
2"	x 1/2"	STD	0,33	60,3	3,91	21,3	2,77	76,2	●				
	x 3/4"	STD	0,33	60,3	3,91	26,7	2,87	76,2	●				
	x 3/4"	XS	0,46	60,3	5,54	26,7	3,91	76,2	●				
	x 3/4"	SCH 160	0,84	60,3	8,74	26,7	5,56	76,2	●				
	x 3/4"	XXS	1,02	60,3	11,07	26,7	7,82	76,2	●				
	x 1"	STD	0,37	60,3	3,91	33,4	3,38	76,2	●	●	●	●	●
	x 1"	XS	0,45	60,3	5,54	33,4	4,55	76,2	●	●	●	●	●
	x 1"	SCH 160	0,84	60,3	8,74	33,4	6,35	76,2	●	●		●	●

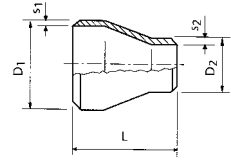

## Concentric Reducers

### Konzentrische Reduzierstücke

Nominal Size Abmessung	kilos/pc. kg/St.	OD D <sub>1</sub>	Wall s <sub>1</sub>	OD D <sub>2</sub>	Wall s <sub>2</sub>	Length Bauhöhe L	SAVA 234 WPB	SAVA 420 WPL6	SAVA 234 WP11	SAVA 234 WP22	SAVA 234 WP5	
		AD D <sub>1</sub>	Wand s <sub>1</sub>	AD D <sub>2</sub>	Wand s <sub>2</sub>							mm
2"	x 1 1/4" STD	0,39	60,3	3,91	42,2	3,56	76,2	●		●	●	
	x 1 1/4" XS	0,53	60,3	5,54	42,2	4,85	76,2	●		●	●	
	x 1 1/4" SCH 160	0,84	60,3	8,74	42,2	6,35	76,2	●				
	x 1 1/2" STD	0,41	60,3	3,91	48,3	3,68	76,2	●	●	●	●	●
	x 1 1/2" XS	0,54	60,3	5,54	48,3	5,08	76,2	●	●	●	●	●
	x 1 1/2" SCH 160	0,84	60,3	8,74	48,3	7,14	76,2	●	●		●	●
2 1/2"	x 1" STD	0,59	73,0	5,16	42,2	3,38	88,9	●				
	x 1" XS	0,79	73,0	7,01	42,2	4,55	88,9	●				
	x 1 1/4" STD	0,67	73,0	5,16	42,2	3,56	88,9	●				
	x 1 1/4" XS	0,78	73,0	7,01	42,2	4,85	88,9	●				
	x 1 1/4" SCH 160	1,33	73,0	9,52	42,2	6,35	88,9	●				
	x 1 1/2" STD	0,68	73,0	5,16	48,3	3,68	88,9	●		●	●	
	x 1 1/2" XS	0,86	73,0	7,01	48,3	5,08	88,9	●		●	●	
	x 1 1/2" SCH 160	1,33	73,0	9,52	48,3	7,14	88,9	●				
	x 2" STD	0,73	73,0	5,16	60,3	3,91	88,9	●	●	●	●	●
	x 2" XS	0,94	73,0	7,01	60,3	5,54	88,9	●	●	●	●	●
	x 2" SCH 160	1,33	73,0	9,52	60,3	8,74	88,9	●				
	3"	x 1" STD	0,74	88,9	5,49	33,4	3,38	88,9	●			
x 1" XS		0,92	88,9	7,62	33,4	4,55	88,9	●				
x 1 1/4" STD		0,77	88,9	5,49	48,3	3,56	88,9	●				
x 1 1/4" XS		1,04	88,9	7,62	48,3	4,85	88,9	●				
x 1 1/2" STD		0,86	88,9	5,49	48,3	3,68	88,9	●				
x 1 1/2" XS		0,99	88,9	7,62	48,3	5,08	88,9	●				
x 2" STD		0,91	88,9	5,49	60,3	3,91	88,9	●	●	●	●	●
x 2" XS		1,18	88,9	7,62	60,3	5,54	88,9	●	●	●	●	●
x 2" SCH 160		1,89	88,9	11,07	60,3	8,74	88,9	●				●
x 2" XXS		2,47	88,9	15,24	60,3	11,07	88,9	●				
x 2 1/2" STD		0,98	88,9	5,49	73,0	5,16	88,9	●		●	●	
x 2 1/2" XS		1,29	88,9	7,62	73,0	7,01	88,9	●		●	●	
x 2 1/2" SCH 160		1,89	88,9	11,07	73,0	9,52	88,9	●				
x 2 1/2" XXS		2,47	88,9	15,24	73,0	14,02	88,9	●				
4"	x 1 1/2" STD	1,24	114,3	6,02	48,3	3,68	101,6	●				
	x 1 1/2" XS	1,73	114,3	8,56	48,3	5,08	101,6	●				
	x 1 1/2" SCH 160	3,42	114,3	13,49	48,3	7,14	101,6				●	
	x 2" STD	1,44	114,3	6,02	60,3	3,91	101,6	●	●			●
	x 2" XS	1,78	114,3	8,56	60,3	5,54	101,6	●	●			●
	x 2" SCH 160	3,41	114,3	13,49	60,3	8,74	101,6	●		●	●	
	x 2" XXS	4,18	114,3	17,12	60,3	11,07	101,6	●				
	x 2 1/2" STD	1,52	114,3	6,02	73,0	5,16	101,6	●		●	●	
	x 2 1/2" XS	2,01	114,3	8,56	73,0	7,01	101,6	●		●	●	
	x 2 1/2" SCH 160	3,41	114,3	13,49	73,0	9,52	101,6	●			●	

## Concentric Reducers

### Konzentrische Reduzierstücke

Nominal Size Abmessung	kilos/pc. kg/St.	OD D <sub>1</sub>	Wall s <sub>1</sub>	OD D <sub>2</sub>	Wall s <sub>2</sub>	Length Bauhöhe L mm	SAVA 234 WPB	SAVA 420 WPL6	SAVA 234 WP11	SAVA 234 WP22	SAVA 234 WP5	
		AD D <sub>1</sub> mm	Wand s <sub>1</sub> mm	AD D <sub>2</sub> mm	Wand s <sub>2</sub> mm							
4"	x 2 1/2" XXS	4,18	114,3	17,12	73,0	14,02	101,6	●				
	x 3" STD	1,59	114,3	6,02	88,9	5,49	101,6	●	●	●	●	●
	x 3" XS	2,13	114,3	8,56	88,9	7,62	101,6	●	●	●	●	●
	x 3" SCH 160	3,41	114,3	13,49	88,9	11,13	101,6	●				●
	x 3" XXS	4,18	114,3	17,12	88,9	15,24	101,6	●				
5"	x 2" STD	2,29	141,3	6,55	60,3	3,91	127,0	●				
	x 2" XS	3,00	141,3	9,52	60,3	5,54	127,0	●				
	x 2 1/2" STD	2,51	141,3	6,55	73,0	5,16	127,0	●				
	x 2 1/2" XS	3,30	141,3	9,52	73,0	7,01	127,0	●				
	x 2 1/2" SCH 160	6,26	141,3	15,88	73,0	9,52	127,0	●				
	x 2 1/2" XXS	7,31	141,3	19,05	73,0	14,02	127,0	●				
	x 3" STD	2,60	141,3	6,55	88,9	5,49	127,0	●		●	●	
	x 3" XS	3,55	141,3	9,52	88,9	7,62	127,0	●		●	●	
	x 3" SCH 160	6,26	141,3	15,88	88,9	11,13	127,0	●				
	x 3" XXS	7,31	141,3	19,05	88,9	15,24	127,0	●				
	x 4" STD	2,72	141,3	6,55	114,3	6,02	127,0	●		●	●	
	x 4" XS	3,78	141,3	9,52	114,3	8,56	127,0	●		●	●	
	x 4" SCH 160	6,26	141,3	15,88	114,3	13,49	127,0	●				
	x 4" XXS	7,31	141,3	19,05	114,3	17,12	127,0	●				
6"	x 2" STD	3,45	168,3	7,11	60,3	3,91	139,7	●				
	x 2" XS	4,52	168,3	10,97	60,3	5,54	139,7	●				
	x 2 1/2" STD	3,45	168,3	7,11	73,0	5,16	139,7	●				
	x 2 1/2" XS	4,52	168,3	10,97	73,0	7,01	139,7	●				
	x 3" STD	3,63	168,3	7,11	88,9	5,49	139,7	●	●			●
	x 3" XS	5,04	168,3	10,97	88,9	7,62	139,7	●	●			●
	x 3" SCH 160	9,40	168,3	18,29	88,9	11,13	139,7	●				
	x 3" XXS	11,08	168,3	21,95	88,9	15,24	139,7	●				
	x 3 1/2" STD	3,72	168,3	7,11	101,6	5,74	139,7	●				
	x 4" STD	3,72	168,3	7,11	114,3	6,02	139,7	●	●	●	●	●
	x 4" XS	5,45	168,3	10,97	114,3	8,56	139,7	●	●	●	●	●
	x 4" SCH 120	8,2	168,3	14,27	114,3	11,13	139,7	●				
	x 4" SCH 160	9,40	168,3	18,29	114,3	13,49	139,7	●				
	x 4" XXS	11,08	168,3	21,95	114,3	17,12	139,7	●				
	x 5" STD	3,93	168,3	7,11	141,3	6,55	139,7	●	●	●	●	
	x 5" XS	5,72	168,3	10,97	141,3	9,52	139,7	●		●	●	
	x 5" SCH 160	9,40	168,3	18,29	141,3	15,88	139,7	●				
	x 5" XXS	11,08	168,3	21,95	141,3	19,05	139,7	●				
8"	x 3" STD	5,81	219,1	8,18	88,9	5,49	152,4	●				
	x 3" XS	7,31	219,1	12,70	88,9	7,62	152,4	●				
	x 4" STD	5,95	219,1	8,18	114,3	6,02	152,4	●	●			●
	x 4" XS	8,44	219,1	12,70	114,3	8,56	152,4	●	●			●

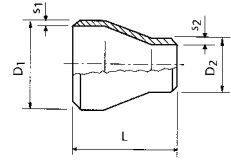

## Concentric Reducers

### Konzentrische Reduzierstücke

Nominal Size Abmessung			kilos/pc. kg/St.	OD D <sub>1</sub> AD D <sub>1</sub>	Wall s <sub>1</sub> Wand s <sub>1</sub>	OD D <sub>2</sub> AD D <sub>2</sub>	Wall s <sub>2</sub> Wand s <sub>2</sub>	Length Bauhöhe L	SAVA 234 WPB	SAVA 420 WPL6	SAVA 234 WP11	SAVA 234 WP22	SAVA 234 WP5
				mm	mm	mm	mm	mm					
8"	x 4"	SCH 160	16,9	219,1	23,01	114,3	13,49	152,4	●				
	x 5"	STD	6,08	219,1	8,18	141,3	6,55	152,4	●		●	●	
	x 5"	XS	8,85	219,1	12,70	141,3	9,52	152,4	●		●	●	
	x 5"	SCH 160	16,90	219,1	23,01	141,3	15,88	152,4	●				
	x 6"	STD	6,31	219,1	8,18	168,3	7,11	152,4	●	●	●	●	●
	x 6"	XS	9,26	219,1	12,70	168,3	10,97	152,4	●	●	●	●	●
	x 6"	SCH 160	16,90	219,1	23,01	168,3	18,26	152,4	●				
10"	x 4"	STD	9,58	273,0	9,27	114,3	6,02	177,8	●				●
	x 4"	XS	11,50	273,0	12,70	114,3	8,56	177,8	●				
	x 5"	STD	9,90	273,0	9,27	168,3	6,55	177,8	●				
	x 5"	XS	13,00	273,0	12,70	168,3	9,52	177,8	●				
	x 6"	STD	10,10	273,0	9,27	168,3	7,11	177,8	●		●		
	x 6"	XS	13,50	273,0	12,70	168,3	10,97	177,8	●		●		
	x 8"	STD	10,50	273,0	9,27	219,1	8,18	177,8	●	●	●		●
	x 8"	XS	14,20	273,0	12,70	219,1	12,70	177,8	●	●	●	●	●
x 8"	SCH 80	18,10	273,0	15,09	219,1	12,70	177,8	●					
12"	x 5"	STD	13,80	323,8	9,52	141,3	6,55	203,2					
	x 5"	XS	17,70	323,8	12,70	141,3	9,52	203,2					
	x 6"	STD	14,10	323,8	9,52	168,3	7,11	203,2	●				
	x 6"	XS	18,40	323,8	12,70	168,3	10,97	203,2	●				
	x 6"	SCH 80	27,34	323,8	17,48	168,3	10,97	203,2	●				
	x 8"	STD	14,60	323,8	9,52	219,1	8,18	203,2	●				
	x 8"	SCH 40	17,15	323,8	10,31	219,1	8,18	203,2					●
	x 8"	XS	19,08	323,8	12,70	219,1	12,70	203,2	●		●		
	x 8"	SCH 80	28,41	323,8	17,48	219,1	12,70	203,2	●				
	x 10"	STD	15,20	323,8	9,52	273,0	9,27	203,2	●		●		●
	x 10"	SCH 40	16,30	323,8	10,31	273,0	9,27	203,2	●				
	x 10"	XS	19,80	323,8	12,70	273,0	12,70	203,2	●		●	●	●
x 10"	SCH 80	29,48	323,8	17,48	273,0	15,09	203,2	●					
14"	x 6"	STD	25,30	355,6	9,52	168,3	7,11	330,2	●				
	x 6"	XS	33,70	355,6	12,70	168,3	10,97	330,2	●				
	x 8"	STD	26,00	355,6	9,52	219,1	8,18	330,2	●				
	x 8"	XS	34,90	355,6	12,70	219,1	12,70	330,2	●				
	x 8"	SCH 80	53,70	355,6	19,05	219,1	12,70	330,2	●				
	x 10"	STD	27,40	355,6	9,52	273,0	9,27	330,2	●				
	x 10"	XS	36,10	355,6	12,70	273,0	12,70	330,2	●				
	x 10"	SCH 80	56,30	355,6	19,05	273,0	15,09	330,2	●				
	x 12"	STD	28,80	355,6	9,52	323,8	9,52	330,2	●				
	x 12"	SCH 40	35,55	355,6	11,13	323,8	10,31	330,2					●
	x 12"	XS	37,70	355,6	12,70	323,8	12,70	330,2	●				

## Concentric Reducers

### Konzentrische Reduzierstücke

Nominal Size Abmessung			kilos/pc. kg/St.	OD D <sub>1</sub> AD D <sub>1</sub> mm	Wall s <sub>1</sub> Wand s <sub>1</sub> mm	OD D <sub>2</sub> AD D <sub>2</sub> mm	Wall s <sub>2</sub> Wand s <sub>2</sub> mm	Length Bauhöhe L mm	SAVA 234 WPB	SAVA 420 WPL6	SAVA 234 WP11	SAVA 234 WP22	SAVA 234 WP5
16"	x 8"	STD	31,90	406,4	9,52	219,1	8,18	355,6	●				
	x 8"	XS	42,60	406,4	12,70	219,1	12,70	355,6	●				
	x 10"	STD	33,10	406,4	9,52	273,0	9,27	355,6	●		●		
	x 10"	XS	43,70	406,4	12,70	273,0	12,70	355,6	●				
	x 12"	STD	34,30	406,4	9,52	323,8	9,52	355,6	●				
	x 12"	XS	45,00	406,4	12,70	323,8	12,70	355,6	●				
	x 12"	SCH 140	128,08	406,4	36,53	323,8	28,58	355,6				●	
	x 14"	STD	35,20	406,4	9,52	355,6	9,52	355,6	●				
	x 14"	XS	46,30	406,4	12,70	355,6	12,70	355,6	●				
	18"	x 10"	STD	39,40	457,2	9,52	273,0	9,27	381,0	●			
x 10"		XS	51,80	457,2	12,70	273,0	12,70	381,0	●				
x 12"		STD	40,50	457,2	9,52	323,8	9,52	381,0	●				
x 12"		XS	53,60	457,2	12,70	323,8	12,70	381,0	●				
x 14"		STD	41,30	457,2	9,52	355,6	9,52	381,0	●				
x 14"		XS	54,50	457,2	12,70	355,6	12,70	381,0	●				
x 16"		STD	42,70	457,2	9,52	406,4	9,52	381,0	●				
x 16"		XS	55,80	457,2	12,70	406,4	12,70	381,0	●				
20"	x 12"	STD	60,80	508,0	9,52	323,8	9,52	508,0	●				
	x 12"	XS	79,90	508,0	12,70	323,8	12,70	508,0	●				
	x 14"	STD	61,30	508,0	9,52	355,6	9,52	508,0	●				
	x 14"	XS	81,30	508,0	12,70	355,6	12,70	508,0	●				
	x 16"	STD	62,60	508,0	9,52	406,4	9,52	508,0	●		●		
	x 16"	XS	82,60	508,0	12,70	406,4	12,70	508,0	●		●		
	x 16"	SCH 40	101,00	508,0	15,09	406,4	12,70	508,0			●		
	x 18"	STD	64,50	508,0	9,52	457,2	9,52	508,0	●		●		
	x 18"	XS	84,40	508,0	12,70	457,2	12,70	508,0	●		●		
	x 18"	SCH 40	101,00	508,0	15,09	457,2	14,27	508,0			●		
22"	x 20"	STD	71,30	558,8	9,52	508,0	9,52	508,0	●				
	x 20"	XS	94,00	558,8	12,70	508,0	12,70	508,0	●				
24"	x 14"	STD	71,90	609,6	9,52	406,4	9,52	508,0	●				
	x 16"	STD	72,60	609,6	9,52	406,4	9,52	508,0	●				
	x 16"	XS	95,80	609,6	12,70	406,4	12,70	508,0	●				
	x 16"	SCH 80	224,41	609,6	30,96	406,4	21,44	508,0	●				
	x 18"	STD	74,00	609,6	9,52	457,2	9,52	508,0	●				
	x 18"	XS	97,60	609,6	12,70	457,2	12,70	508,0	●				
	x 18"	SCH 30	108,58	609,6	14,27	457,2	11,13	508,0	●				
	x 20"	STD	75,80	609,6	9,52	508,0	9,52	508,0	●				
	x 20"	XS	99,90	609,6	12,70	508,0	12,70	508,0	●				
	x 20"	SCH 80	233,39	609,6	30,96	508,0	26,19	508,0	●				

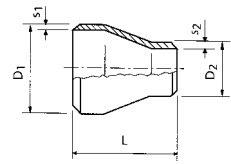

## Eccentric Reducers

### Exzentrische Reduzierstücke

Nominal Size Abmessung	kilos/pc. kg/St.	OD D <sub>1</sub>	Wall s <sub>1</sub>	OD D <sub>2</sub>	Wall s <sub>2</sub>	Length Bauhöhe	SAVA 234 WPB	SAVA 420 WPL6	SAVA 234 WP5		
		AD D <sub>1</sub>	Wand s <sub>1</sub> L	AD D <sub>2</sub>	Wand s <sub>2</sub>					mm	mm
3/4"	x 1/2" STD	0,09	26,7	2,87	21,3	2,77	38,1	●			
	x 1/2" XS	0,12	26,7	3,91	21,3	3,73	38,1	●			
	x 1/2" SCH 160	0,13	26,7	5,56	21,3	4,78	38,1	●			
1"	x 1/2" STD	0,14	33,4	3,38	21,3	2,77	50,8	●	●		
	x 1/2" XS	0,16	33,4	4,55	21,3	3,73	50,8	●	●		
	x 1/2" SCH 160	0,22	33,4	6,35	21,3	4,78	50,8	●	●		
	x 3/4" STD	0,14	33,4	3,38	26,7	2,87	50,8	●	●	●	
	x 3/4" XS	0,17	33,4	4,55	26,7	3,91	50,8	●	●	●	
	x 3/4" SCH 160	0,22	33,4	6,35	26,7	5,56	50,8	●	●		
1 1/4"	x 1/2" XS	0,22	42,2	4,85	21,3	3,73	50,8	●			
	x 3/4" STD	0,20	42,2	3,56	26,7	2,87	50,8	●			
	x 3/4" XS	0,23	42,2	4,88	26,7	3,91	50,8	●			
	x 1" STD	0,20	42,2	3,56	33,4	3,38	50,8	●	●		
	x 1" XS	0,24	42,2	4,85	33,4	4,55	50,8	●	●		
1 1/2"	x 1/2" STD	0,20	48,3	3,68	21,3	2,77	63,5	●			
	x 1/2" XS	0,28	48,3	5,08	21,3	3,73	63,5	●			
	x 3/4" STD	0,22	48,3	3,68	26,7	2,87	63,5	●			
	x 3/4" XS	0,27	48,3	5,08	26,7	3,91	63,5	●			
	x 3/4" SCH 160	0,51	48,3	7,14	26,7	5,56	63,5	●			
	x 1" STD	0,24	48,3	3,68	33,4	3,38	63,5	●			
	x 1" XS	0,31	48,3	5,08	33,4	4,55	63,5	●			
	x 1" SCH 160	0,55	48,3	7,14	33,4	6,35	63,5	●			
	x 1" XXS	0,73	48,3	10,16	33,4	9,09	63,5	●			
	x 1 1/4" STD	0,26	48,3	3,68	42,2	3,56	63,5	●	●		
	x 1 1/4" XS	0,33	48,3	5,08	42,2	4,85	63,5	●	●		
	2"	x 3/4" STD	0,33	60,3	3,91	26,7	2,87	76,2			
		x 3/4" XS	0,46	60,3	5,54	26,7	3,91	76,2			
x 1" STD		0,37	60,3	3,91	33,4	3,38	76,2	●	●	●	
x 1" XS		0,45	60,3	5,54	33,4	4,55	76,2	●	●	●	
x 1" SCH 160		0,94	60,3	8,74	33,4	6,35	76,2	●	●		
x 1" XXS		1,14	60,3	11,07	33,4	9,09	76,2	●			
x 1 1/4" STD		0,39	60,3	3,91	42,2	3,56	76,2	●			
x 1 1/4" XS		0,53	60,3	5,54	42,2	4,85	76,2	●			
x 1 1/2" STD		0,41	60,3	3,91	48,3	3,68	76,2	●			
x 1 1/2" XS		0,54	60,3	5,54	48,3	5,08	76,2	●			
x 1 1/2" SCH 160		1,04	60,3	8,74	48,3	7,14	76,2	●			
x 1 1/2" XXS		1,26	60,3	11,07	48,3	10,16	76,2	●			
2 1/2"		x 1" STD	0,59	73,0	5,16	42,2	3,38	88,9	●		
		x 1" XS	0,79	73,0	7,01	42,2	4,55	88,9	●		

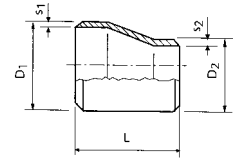

## Eccentric Reducers

### Exzentrische Reduzierstücke

Nominal Size Abmessung		kilos/pc. kg/St.	OD D <sub>1</sub> AD D <sub>1</sub> mm	Wall s <sub>1</sub> Wand s <sub>1</sub> L mm	OD D <sub>2</sub> AD D <sub>2</sub> mm	Wall s <sub>2</sub> Wand s <sub>2</sub> mm	Length Bauhöhe mm	SAVA 234 WPB	SAVA 420 WPL6	SAVA 234 WP5
2 1/2"	x 1 1/4" STD	0,67	73,0	5,16	42,2	3,56	88,9	●		
	x 1 1/4" XS	0,78	73,0	7,01	42,2	4,85	88,9	●		
	x 1 1/2" STD	0,68	73,0	5,16	48,3	3,68	88,9	●		
	x 1 1/2" XS	0,86	73,0	7,01	48,3	5,08	88,9	●		
	x 2" STD	0,73	73,0	5,16	60,3	3,91	88,9	●	●	
	x 2" XS	0,94	73,0	7,01	60,3	5,54	88,9	●	●	
3"	x 1" STD	0,74	88,9	5,49	33,4	3,38	88,9	●		
	x 1" XS	0,92	88,9	7,62	33,4	4,55	88,9	●		
	x 1 1/4" STD	0,77	88,9	5,49	48,3	3,56	88,9	●		
	x 1 1/4" XS	1,04	88,9	7,62	48,3	4,85	88,9	●		
	x 1 1/2" STD	0,86	88,9	5,49	48,3	3,68	88,9	●		
	x 1 1/2" XS	0,99	88,9	7,62	48,3	5,08	88,9	●		
	x 1 1/2" SCH 160	2,12	88,9	11,13	48,3	7,14	88,9	●		
	x 1 1/2" XXS	2,76	88,9	15,24	48,3	10,16	88,9	●		
	x 2" STD	0,91	88,9	5,49	60,3	3,91	88,9	●	●	●
	x 2" XS	1,18	88,9	7,62	60,3	5,54	88,9	●	●	●
	x 2" SCH 160	2,23	88,9	11,13	60,3	8,74	88,9	●		●
	x 2 1/2" STD	0,98	88,9	5,49	73,0	5,16	88,9	●		
	x 2 1/2" XS	1,29	88,9	7,62	73,0	7,01	88,9	●		
	4"	x 1 1/2" STD	1,24	114,3	6,02	48,3	3,68	101,6	●	
x 1 1/2" XS		1,73	114,3	8,56	48,3	5,08	101,6	●		
x 1 1/2" SCH 160		3,42	114,3	13,49	48,3	7,14	101,6	●		
x 2" STD		1,44	114,3	6,02	60,3	3,91	101,6	●	●	
x 2" XS		1,78	114,3	8,56	60,3	5,54	101,6	●	●	
x 2" SCH 160		3,97	114,3	13,49	60,3	8,74	101,6	●		
x 2 1/2" STD		1,52	114,3	6,02	73,0	5,16	101,6	●		
x 2 1/2" XS		2,01	114,3	8,56	73,0	7,01	101,6	●		
x 3" STD		1,59	114,3	6,02	88,9	5,49	101,6	●	●	●
x 3" XS		2,13	114,3	8,56	88,9	7,62	101,6	●	●	●
5"		x 2" STD	2,29	141,3	6,55	60,3	3,91	127,0		
	x 2" XS	3,00	141,3	9,52	60,3	5,54	127,0			
	x 2 1/2" STD	2,51	141,3	6,55	73,0	5,16	127,0	●		
	x 2 1/2" XS	3,30	141,3	9,52	73,0	7,01	127,0	●		
	x 3" STD	2,60	141,3	6,55	88,9	5,49	127,0	●		
	x 3" XS	3,55	141,3	9,52	88,9	7,62	127,0	●		
	x 4" STD	2,72	141,3	6,55	114,3	6,02	127,0	●		
	x 4" XS	3,78	141,3	9,52	114,3	8,56	127,0	●		
6"	x 2 1/2" STD	3,45	168,3	7,11	73,0	5,16	139,7	●		
	x 2 1/2" XS	4,52	168,3	10,97	73,0	7,01	139,7	●		
	x 3" STD	3,63	168,3	7,11	88,9	5,49	139,7	●	●	

## Eccentric Reducers

### Exzentrische Reduzierstücke

Nominal Size Abmessung			kilos/pc. kg/St.	OD D <sub>1</sub> AD D <sub>1</sub> mm	Wall s <sub>1</sub> Wand s <sub>1</sub> L mm	OD D <sub>2</sub> AD D <sub>2</sub> mm	Wall s <sub>2</sub> Wand s <sub>2</sub> mm	Length Bauhöhe mm	SAVA 234 WPB	SAVA 420 WPL6	SAVA 234 WP5
<b>6"</b>	x 3"	XS	5,04	168,3	10,97	88,9	7,62	139,7	●	●	
	x 4"	STD	3,72	168,3	7,11	114,3	6,02	139,7	●	●	●
	x 4"	XS	5,45	168,3	10,97	114,3	8,56	139,7	●	●	●
	x 4"	SCH 120	8,20	168,3	14,27	114,3	11,13	139,7	●		
	x 4"	SCH 160	10,22	168,3	18,26	114,3	13,49	139,7	●		
	x 5"	STD	3,93	168,3	7,11	141,3	6,55	139,7	●		
	x 5"	XS	5,72	168,3	10,97	141,3	9,52	139,7	●		
<b>8"</b>	x 3"	STD	5,81	219,1	8,18	88,9	5,49	152,4	●		
	x 3"	XS	7,31	219,1	12,70	88,9	7,62	152,4	●		
	x 4"	STD	5,95	219,1	8,18	114,3	6,02	152,4	●	●	
	x 4"	XS	8,44	219,1	12,70	114,3	8,56	152,4	●	●	
	x 5"	STD	6,08	219,1	8,18	141,3	6,55	152,4	●		
	x 5"	XS	8,85	219,1	12,70	141,3	9,52	152,4	●		
	x 6"	STD	6,31	219,1	8,18	168,3	7,11	152,4	●	●	●
	x 6"	XS	9,26	219,1	12,70	168,3	10,97	152,4	●	●	●
<b>10"</b>	x 4"	STD	9,58	273,0	9,27	114,3	6,02	177,8	●		
	x 4"	XS	11,50	273,0	12,70	114,3	8,56	177,8	●		
	x 5"	STD	9,90	273,0	9,27	168,3	6,55	177,8	●		
	x 5"	XS	13,00	273,0	12,70	168,3	9,52	177,8	●		
	x 6"	STD	10,10	273,0	9,27	168,3	7,11	177,8	●		
	x 6"	XS	13,50	273,0	12,70	168,3	10,97	177,8	●		
	x 8"	STD	10,50	273,0	9,27	219,1	8,18	177,8	●	●	●
	x 8"	XS	14,20	273,0	12,70	219,1	12,70	177,8	●	●	●
<b>12"</b>	x 5"	STD	13,80	323,8	9,52	141,3	6,55	203,2			
	x 5"	XS	17,70	323,8	12,70	141,3	9,52	203,2			
	x 6"	STD	14,10	323,8	9,52	168,3	7,11	203,2	●		
	x 6"	XS	18,40	323,8	12,70	168,3	10,97	203,2	●		
	x 8"	STD	14,60	323,8	9,52	219,1	8,18	203,2	●		
	x 8"	XS	17,00	323,8	12,70	219,1	12,70	203,2	●		
	x 8"	SCH 60	23,45	323,8	14,27	219,1	10,31	203,2	●		
	x 8"	SCH 160	51,37	323,8	33,32	219,1	23,01	203,2	●		
	x 10"	STD	15,20	323,8	9,52	273,0	9,27	203,2	●		●
	x 10"	XS	19,80	323,8	12,70	273,0	12,70	203,2	●		●
	x 10"	SCH 60	24,33	323,8	14,27	273,0	12,70	203,2	●		
<b>14"</b>	x 6"	STD	25,30	355,6	9,52	168,3	7,11	330,2	●		
	x 6"	XS	33,70	355,6	12,70	168,3	10,97	330,2	●		
	x 8"	STD	26,00	355,6	9,52	219,1	8,18	330,2	●		
	x 8"	XS	34,90	355,6	12,70	219,1	12,70	330,2	●		
	x 10"	STD	27,40	355,6	9,52	273,0	9,27	330,2	●		
	x 10"	XS	36,10	355,6	12,70	273,0	12,70	330,2	●		

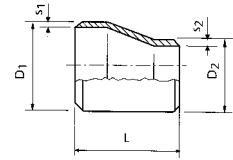

## Eccentric Reducers

### Exzentrische Reduzierstücke

Nominal Size Abmessung			kilos/pc. kg/St.	OD D <sub>1</sub> AD D <sub>1</sub> mm	Wall s <sub>1</sub> Wand s <sub>1</sub> L mm	OD D <sub>2</sub> AD D <sub>2</sub> mm	Wall s <sub>2</sub> Wand s <sub>2</sub> mm	Length Bauhöhe mm	SAVA 234 WPB	SAVA 420 WPL6	SAVA 234 WP5
14"	x 12"	STD	28,80	355,6	9,52	323,8	9,52	330,2	●		
	x 12"	SCH 40	28,80	355,6	11,13	323,8	10,31	330,2	●		
	x 12"	XS	37,70	355,6	12,70	323,8	12,70	330,2	●		
16"	x 8"	STD	31,90	406,4	9,52	219,1	8,18	355,6	●		
	x 8"	XS	42,60	406,4	12,70	219,1	12,70	355,6	●		
	x 8"	SCH 80	72,44	406,4	21,44	219,1	12,70	355,6	●		
	x 10"	STD	33,10	406,4	9,52	273,0	9,27	355,6	●		
	x 10"	XS	43,70	406,4	12,70	273,0	12,70	355,6	●		
	x 12"	STD	34,30	406,4	9,52	323,8	9,52	355,6	●		●
	x 12"	XS	45,00	406,4	12,70	323,8	12,70	355,6	●		●
	x 12"	SCH 60	61,39	406,4	16,66	323,8	14,27	355,6	●		●
	x 14"	STD	35,20	406,4	9,52	355,6	9,52	355,6	●		
	x 14"	XS	46,30	406,4	12,70	355,6	12,70	355,6	●		
18"	x 10"	STD	39,40	457,2	9,52	273,0	9,27	381,0			
	x 10"	XS	51,80	457,2	12,70	273,0	12,70	381,0			
	x 12"	STD	40,50	457,2	9,52	323,8	9,52	381,0	●		
	x 12"	XS	53,60	457,2	12,70	323,8	12,70	381,0	●		
	x 14"	STD	41,30	457,2	9,52	355,6	9,52	381,0	●		
	x 14"	XS	54,50	457,2	12,70	355,6	12,70	381,0	●		
	x 16"	STD	42,70	457,2	9,52	406,4	9,52	381,0	●		
	x 16"	XS	55,80	457,2	12,70	406,4	12,70	381,0	●		
	x 16"	SCH 40	64,15	457,2	14,27	406,4	12,70	381,0	●		
	x 16"	SCH 60	84,68	457,2	19,05	406,4	16,66	381,0	●		●
20"	x 10"	STD	59,90	508,0	9,52	273,0	9,52	508,0	●		
	x 12"	STD	60,80	508,0	9,52	323,8	9,52	508,0	●		
	x 12"	XS	79,90	508,0	12,70	323,8	12,70	508,0	●		
	x 14"	STD	61,30	508,0	9,52	355,6	9,52	508,0	●		
	x 14"	XS	81,30	508,0	12,70	355,6	12,70	508,0	●		
	x 16"	STD	62,60	508,0	9,52	406,4	9,52	508,0	●		
	x 16"	XS	82,60	508,0	12,70	406,4	12,70	508,0	●		
	x 16"	SCH 60	129,69	508,0	20,62	406,4	16,66	508,0			●
	x 18"	STD	64,50	508,0	9,52	457,2	9,52	508,0	●		
	x 18"	XS	84,40	508,0	12,70	457,2	12,70	508,0	●		
24"	x 16"	STD	72,60	609,9	9,52	406,4	9,52	508,0	●		
	x 16"	XS	95,80	609,6	12,70	406,4	12,70	508,0	●		
	x 16"	SCH 60	180,35	609,6	24,61	406,4	16,66	508,0			●
	x 18"	STD	74,00	609,6	9,52	457,2	9,52	508,0	●		
	x 18"	XS	97,60	609,6	12,70	457,2	12,70	508,0	●		
	x 20"	STD	75,80	609,6	9,52	508,0	9,52	508,0	●		
	x 20"	XS	99,90	609,6	12,70	508,0	12,70	508,0	●		

# Caps

## Kappen

Nominal Size Abmessung		kilos/pc. kg/St.	OD AD D mm	Wall Wand s <sub>1</sub> mm	Length Bauhöhe H mm	SAVA 234 WPB	SAVA 234 WPL6	SAVA 234 WP11	SAVA 234 WP22
1/2"	STD	0,03	21,30	2,77	25,40	●	●	●	●
	XS	0,04	21,30	3,73	25,40	●	●	●	●
	SCH 160	0,06	21,30	4,78	25,90	●			
3/4"	STD	0,06	26,70	2,87	25,40	●	●	●	●
	XS	0,07	26,70	3,91	25,40	●	●	●	●
1"	STD	0,10	33,40	3,38	38,10	●	●	●	●
	XS	0,13	33,40	4,55	38,10	●	●	●	●
	SCH 160	0,15	33,40	6,35	38,10	●			●
1 1/4"	STD	0,14	42,20	3,56	38,10	●	●	●	●
	XS	0,18	42,20	4,85	38,10	●	●	●	●
1 1/2"	STD	0,17	48,30	3,68	38,10	●	●	●	●
	XS	0,22	48,30	5,08	38,10	●	●	●	●
	SCH 160	0,30	48,30	7,14	38,10	●			
	XXS	0,35	48,30	10,16	38,10				●
2"	STD	0,23	60,30	3,91	38,10	●	●	●	●
	XS	0,30	60,30	5,54	38,10	●	●	●	●
	SCH 160	0,55	60,30	8,74	38,10	●			
	XXS	0,60	60,30	11,07	38,10				●
2 1/2"	STD	0,37	73,00	5,16	38,10	●	●	●	●
	XS	0,46	73,00	7,01	38,10	●	●	●	●
	SCH 160	0,90	73,00	9,52	38,10	●			
3"	STD	0,64	88,90	5,49	50,80	●	●	●	●
	XS	0,84	88,90	7,62	50,80	●	●	●	●
	SCH 160	1,45	88,90	11,13	50,80	●			
4"	STD	1,16	114,30	6,02	63,50	●	●	●	●
	XS	1,55	114,30	8,56	63,50	●	●	●	●
	SCH 160	2,75	114,30	13,49	63,40	●			
5"	STD	1,91	141,30	6,55	76,20	●	●	●	●
	XS	2,61	141,30	9,52	76,20	●	●	●	●
6"	STD	2,91	168,30	7,11	88,90	●	●	●	●
	XS	4,19	168,30	10,97	88,90	●	●	●	●

# Caps

## Kappen

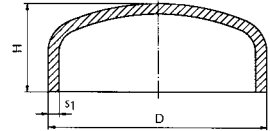

Nominal Size Abmessung		kilos/pc. kg/St.	OD AD D mm	Wall Wand s <sub>1</sub> mm	Length Bauhöhe H mm	SAVA 234 WPB	SAVA 234 WPL6	SAVA 234 WP11	SAVA 234 WP22
8"	Sch 20	4,50	219,10	6,35	101,60	●			
	STD	5,50	219,10	8,18	101,60	●	●	●	●
	Sch 60	7,00	219,10	10,31	101,60	●			
	XS	7,40	219,10	12,70	101,60	●	●	●	●
10"	STD	9,08	273,00	9,27	127,00	●	●	●	●
	XS	11,90	273,00	12,70	127,00	●	●	●	●
12"	STD	13,40	323,80	9,52	152,40	●	●	●	●
	XS	17,30	323,80	12,70	152,40	●	●	●	●
14"	STD	16,00	355,60	9,52	165,10	●	●	●	●
	XS	20,80	355,60	12,70	165,10	●	●	●	●
16"	STD	20,10	406,40	9,52	177,80	●	●	●	●
	XS	26,10	406,40	12,70	177,80	●	●	●	●
	Sch 60	40,75	406,40	16,66	177,80	●			
18"	STD	25,90	457,20	9,52	203,20	●			
	XS	33,90	457,20	12,70	203,20	●			
	Sch 60	66,00	457,20	19,05	203,20	●			
20"	STD	32,50	508,00	9,52	228,60	●			
	XS	42,60	508,00	12,70	228,60	●			
24"	STD	46,30	609,60	9,52	266,70	●		●	
	XS	60,80	609,60	12,70	266,70	●			

## Technical Data

### Technische Daten

#### Applicable Pipe Specifications

Anwendbare Normen für Rohre

Designation Bezeichnung	Titel Titel
ASTM A 53	Black and Hot-Dipped, Zinc-Coated, Welded and Seamless Steel Pipe
ASTM A 106	Seamless Carbon Steel Pipe for High-Temperature Service
ASTM A 120	Black and Hot-Dipped Zinc-Coated (Galvanized) Welded and Seamless Steel Pipe for Ordinary Uses
ASTM A 134	Electric-Fusion (Arc)-Welded Steel Pipe (Sizes NPS 16 and Over)
ASTM A 135	Electric-Resistance-Welded Steel Pipe
ASTM A 139	Electric-Fusion (Arc)-Welded Steel Pipe (NPS 4 and Over)
ASTM A 211	Spiral-Welded Steel or Iron Pipe
ASTM A 312	Seamless and Welded Austenitic Stainless Steel Pipes
ASTM A 333	Seamless and Welded Steel Pipe for Low-Temperature Service
ASTM A 335	Seamless Ferritic Alloy-Steel Pipe for High-Temperature Service
ASTM A 358	Electric-Fusion-Welded Austenitic Chromium-Nickel Alloy Steel Pipe for High-Temperature Service
ASTM A 369	Carbon and Ferritic Alloy Steel Forged and Bored Pipe for High-Temperature Service
ASTM A 376	Seamless Austenitic Steel Pipe for High-Temperature Central-Station Service
ASTM A 381	Metal-Arc-Welded Steel Pipe for Use With High-Pressure Transmission Systems
ASTM A 405	Seamless Ferritic Alloy-Steel Pipe Specially Heat Treated for High-Temperature Service
ASTM A 409	Welded Large Diameter Austenitic Steel Pipe for Corrosive or High-Temperature Service
ASTM A 430	Austenitic Steel Forged and Bored Pipe for High-Temperature Service
ASTM A 523	Plain End Seamless and Electric-Resistance-Welded Steel Pipe for High-Pressure Pipe-Type Cable Circuits
ASTM A 524	Seamless Carbon Steel Pipe for Atmospheric and Lower Temperatures
ASTM A 530	General Requirements for Specialized Carbon and Alloy Steel Pipe
ASTM A 671	Electric-Fusion-Welded Steel Pipe for Atmospheric and Lower Temperatures
ASTM A 672	Electric-Fusion-Welded Steel Pipe for High-Pressure Service at Moderate Temperatures
ASTM A 691	Carbon and Alloy Steel Pipe, Electric-Fusion-Welded for High-Pressure Service at High Temperatures
ASTM A 714	High-Strength Low-Alloy Welded and Seamless Steel Pipe
ASTM A 731	Seamless, Welded Ferritic, and Martensitic Stainless Steel Pipe
ASTM A 790	Seamless and Welded Ferritic/Austenitic Stainless Steel Pipe
ASTM A 795	Black and Hot-Dipped Zinc-Coated (Galvanized) Welded and Seamless Steel Pipe for Fire Protection Use
ASTM A 999	General Requirements for Alloy and Stainless Steel Pipes
API 5L	Line Pipe

## Technical Data

### Technische Daten

**Comparison Table – Service Temperatures for Boiler and Heatexchanger Tubes**

Vergleichstabelle – Betriebstemperaturen für Kessel und Wärmetauscherrohre

Max. Service Temperature Max. Betriebstemperatur	ASTM  (USA)	DIN 17175  (Germany)	BS 3059-3601 3602-3603 3604-3606  (U.K.)	AFNOR NF A 49-213 NF A 49-215  (France)	EN 10216-2  (Europe)	JIS G 3456 G 3458 G 3461 G 3462 (Japan)
– 100° C – 40° C	A 334 Gr. 3 A 334 Gr. 146		503 LT 430 LT	TU 10 N 14 TU 42 BT		
475° C	A 179 A 106 Gr. A A 192	St35.8	320 360	TU 37 C	P235GH	STPT 38 STB 35
	A 106 Gr. B A 210 Gr. A1	St45.8	430	TU 42 C	P265GH	STPT 42 STB 42
	A 106 Gr. C A 210 Gr. C	17Mn4	440	TU 48 C		STPT 49
		19Mn5	500 Nb	TU 52 C		STB 52
500° C		15Mo3	243	TU 15 D 3	16Mo3	
	A 209 T1 A 335 P1	16Mo5 (VD TÜV)	245		16Mo3	STBA 12 STPA 12 STBA 13
550° C	A 213 T2 A 335 P12			TU 15 CD 2.05		STBA 20 STPA 20
560° C	A 213 T12 A 335 P12	13CrMo44	620-460	TU 13 CD 4.04	13CrMo4-5	STBA 22 STPA 22
575° C	A 213 T11 A 335 P11		621	TU 10 CD 5.05		STBA 22 STPA 23
600° C	A 213 T5 A 335 P5 A 213 T22 A 335 P22	12CrMo195  10CrMo910	625  622-490	TU Z 10 CD 05.05 TU Z 12 CD 05.05 TU 10 C 9.10	X11CrMo5  10CrMo9-10	STBA 25 STPA 25 STBA 24 STPA 24
		14MoV63				
625° C	A 213 T9 A 335 P9	X12CrMo91 (VD TÜV)	629-470 629-490	TU Z 10 CD 09	11CrMo9-10	STBA 26 STPA 26
650° C	A 213 T91 A 335 P91	X10CrMoVNb9-1		TU Z 10 CDVNb 09.01 TU Z 10 CDNbV 09.02	X10CrMoVNb9-1	

# Technical Data

## Technische Daten

**Comparison Table – International Standards**  
Vergleichstabelle – Internationale Normen

Steel No.	DIN	Grade	EN	Grade	ASTM	Grade	NFA	Grade	BS	Grade
1.0305	17175	S35.8	EN 10216-2	P235GH	A 106	A	49213	TU 37 C	3059: Part 2	360
									3602: Part 1	360
1.0405	17175	S45.8	EN 10216-2	P265GH	A 106	B	49213	TU 42 C	3059: Part 2	440
									3602: Part 1	430
1.5415	17175	15Mo3	EN 10216-2	16Mo3			49213	TU 15 D 3	3059: Part 2	243
	17175	16Mo3	EN 10216-2	16Mo3	A 335	P1			3606	245
1.7335	17175	13CrMo44	EN 10216-2	13CrMo4-5	A 335	P2	49213	TU 15 CD 2.05		
	17175		EN 10216-2		A 335	P12	49213	TU 13 CD 4.04	3059: Part 2	620
1.7380	17175	10CrMo910	EN 10216-2	10CrMo9-10	A 335	P11	49213	TU 10 CD 5.05	3604	620
									3604	621
1.7386	17175	12CrMo195	EN 10216-2	X11CrMo5	A 335	P22	49213	TU 10 CD 9.10	3059: Part 2	622-440
	17176	X12CrMo5	EN 10216-2	X11CrMo5	A 335	P5	49213	TU 10 CD 5-05	3059: Part 2	622-490
1.4922	17175	X20CrMoV12-1	EN 10216-2	X20CrMoV11-1	A 335	P9	49213	TU 10 CD 09	3604	622
									3059: Part 2	625
1.4903	17175	X10CrMoVNb9-1	EN 10216-2	X10CrMoVNb9-1	A 335	P91	49213	TU Z 10 CD VNb 09.01	3604	625
	17173	TTS35NV	EN 10216-4	P215NL / P255QL	A 333	1			3059: Part 2	91
1.5637	17173	10Ni14	EN 10222-3	12Ni14	A 333	6	49215	TU 42 BT	3603: 1991	430 LT
	17456/58	X5CrNi1810	EN 10216-5	X5CrNi18-10	A 213 / A 312	3	49215	TU 10 N 14	3603: 1991	503 LT
1.4301	17456/58	X2CrNi1911	EN 10216-5	X2CrNi19-11	A 213 / A 312	TP 304	49117	Z 6 CN 18.09	3605	304 S 31
	17456/58	X5CrNiMo17122	EN 10216-5	X5CrNiMo17-12-2	A 213 / A 312	TP 304 L	49117	Z 2 CN 18.10	3605	304 S 11
1.4401	17456/58	X2CrNiMo17132	EN 10216-5	X2CrNiMo17-12-2	A 213 / A 312	TP 316	49117	Z 6 CND 17.11	3605	316 S 31
	17456/58	X2CrNiMo18143	EN 10216-5	X2CrNiMo18-14-3	A 213 / A 312	TP 316 LN	49117	Z 2 CND 17.12	3605	316 S 11
1.4435	17456/58	X5CrNiMo17133	EN 10216-5	X3CrNiMo17-13-3	A 213 / A 312	TP 316 LN	35572	Z 2 CND 17.13	3606	316 S 13
	17456/58	X2CrNiMo17135	EN 10216-5	X2CrNiMo17-13-5	A 213 / A 312	TP 316	35572	Z 6 CND 17.12	3606	316 S 33
1.4541	17456/58	X6CrNiTi1810	EN 10216-5	X6CrNiTi18-10	A 213 / A 312	TP 321	35584	Z 2 CNDU 17.16		
	17456/58	X6CrNiNb1810	EN 10216-5	X6CrNiNb18-10	A 213 / A 312	TP 347	49117	Z 6 CNT 18.10	3605	321 S 31
1.4571	17456/58	X6CrNiMoTi17122	EN 10216-5	X6CrNiMoTi17-12-2	A 213 / A 312	TP 316 Ti	35572	Z 6 CND 18.10	3605	347 S 31
							49117	Z 6 CNDT 17.12	970/4	320 S 17

# Technical Data

## Technische Daten

### Wall Thicknesses and Weights Wandstärken und Gewichte

Nominal Pipe Size	Outside Dia- meter	ANSI B 36.10										ANSI B 36.19									
		Schedule 10	Schedule 20	Schedule 30	Schedule STD	Schedule 40	Schedule 60	Schedule XS	Schedule 80	Schedule 100	Schedule 120	Schedule 140	Schedule 160	Schedule XXS	Schedule 5S	Schedule 10S	Schedule 40S	Schedule 80S			
		mm	kg/m	mm	kg/m	mm	kg/m	mm	kg/m	mm	kg/m	mm	kg/m	mm	kg/m	mm	kg/m	mm	kg/m		
1/4"	13.7				2.24	0.63	3.02	0.80	3.02	0.80						1.65	0.50	2.24	0.64	3.02	0.81
3/8"	17.1				2.31	0.84	3.20	1.10	3.20	1.10						1.65	0.64	2.31	0.86	3.20	1.12
1/2"	21.3				2.77	1.27	3.73	1.62	3.73	1.62						4.78	1.95	2.77	1.29	3.73	1.65
3/4"	26.7				2.87	1.69	3.91	2.20	3.91	2.20						5.56	2.90	2.87	1.71	3.91	2.23
1"	33.4				3.38	2.50	4.55	3.24	4.55	3.24						6.35	4.24	3.38	2.54	4.55	3.29
1 1/4"	42.2				3.56	3.39	4.85	4.47	4.85	4.47						6.35	5.61	3.56	3.44	4.85	4.53
1 1/2"	48.3				3.68	4.05	5.08	5.41	5.08	5.41						7.14	7.25	3.68	4.11	5.08	5.49
2"	60.3				3.91	5.44	5.54	7.48	5.54	7.48						8.74	11.11	3.91	5.52	5.54	7.60
2 1/2"	73.0				5.16	8.63	7.01	11.41	7.01	11.41						9.53	14.92	5.16	8.77	7.01	11.59
3"	88.9				5.49	11.29	7.62	15.27	7.62	15.27						11.13	21.35	5.49	11.47	7.62	15.51
3 1/2"	101.6				5.74	13.57	8.08	18.63	8.08	18.63								5.74	13.78	8.08	18.92
4"	114.3				6.02	16.07	8.56	22.32	8.56	22.32						13.49	33.54	6.02	16.32	8.56	22.67
5"	141.3				6.55	21.77	9.53	30.97	9.53	30.97						15.88	49.11	6.55	22.10	9.53	31.44
6"	168.3				7.11	28.26	10.97	42.56	10.97	42.56						18.26	67.56	7.11	28.70	10.97	43.22
8"	219.1				8.35	33.31	12.70	64.64	12.70	64.64						23.01	111.20	8.35	43.20	12.70	65.64
10"	273.0				9.27	60.31	18.26	114.70	18.26	114.70						34.00	172.30	9.27	61.22	12.70	82.78
12"	323.8				10.31	79.73	21.44	159.90	21.44	159.90						41.90	238.70	10.31	74.94	12.70	98.96
14"	355.6				11.13	94.55	23.83	194.90	23.83	194.90						47.80	281.70	11.13	82.50	12.70	109.05
16"	406.4				12.70	123.30	26.19	245.50	26.19	245.50						55.40	365.30	12.70	94.61	12.70	125.20
18"	457.2				14.27	155.80	29.36	309.60	29.36	309.60						63.70	459.30	14.27	106.83	12.70	141.35
20"	508.0				15.09	183.40	31.10	381.50	31.10	381.50						72.10	564.80	15.09	118.95	12.70	157.51
22"	558.8				17.48	255.40	41.28	527.00	41.28	527.00						83.80	672.20	17.48	131.07	12.70	173.66
24"	609.6				19.05	355.20	46.02	640.00	46.02	640.00						95.92	808.20	19.05	143.20	12.70	189.82
26"	660.4				21.70	528.00	55.40	1020.00	55.40	1020.00						111.30	1020.00	21.70	155.22	12.70	205.85
28"	711.2				24.60	748.00	66.00	1416.00	66.00	1416.00						130.00	1416.00	24.60	167.39	12.70	222.06
30"	762.0				27.60	1020.00	79.20	1944.00	79.20	1944.00						150.00	1944.00	27.60	179.56	12.70	238.28
32"	812.8				30.70	1380.00	92.40	2688.00	92.40	2688.00						171.60	2688.00	30.70	191.73	12.70	254.50
34"	863.6				33.90	1848.00	106.80	3696.00	106.80	3696.00						193.20	3696.00	33.90	203.90	12.70	270.72
36"	914.4				37.20	2448.00	122.40	4968.00	122.40	4968.00						215.80	4968.00	37.20	215.83	12.70	286.62

# BUHLMANN GROUP

## BUHLMANN GRUPPE

■ **Bremen** Arberger Hafendamm 1, 28309 Bremen, Germany  
Tel.: +49 421 4586-0, Fax: +49 421 4586750  
tubes+fittings.hb@buhlmann.de

■ **Hilden** Lise-Meitner-Straße 14, 40721 Hilden, Germany  
Tel.: +49 2103 578-0, Fax: +49 2103 578115  
tubes+fittings.me@buhlmann.de

■ **Duisburg** Bliersheimer Straße 33, 47229 Duisburg, Germany  
Tel.: +49 2103 578-0, Fax: +49 2103 578151  
tubes+fittings.du@buhlmann.de

■ **Mannheim** Ruhrorter Straße 35-39, 68219 Mannheim, Germany  
Tel.: +49 621 3242-0, Fax: +49 621 3242111  
tubes+fittings.ma@buhlmann.de

■ **Burghausen** Gewerbepark Lindach A10, 84489 Burghausen, Germany  
Tel.: +49 8677 8816-0, Fax: +49 8677 881650  
tubes+fittings.ao@buhlmann.de

■ **Chemnitz** Dresdner Straße 11, 09111 Chemnitz, Germany  
Tel.: +49 371 43137-0, Fax: +49 371 4313718  
tubes+fittings.c@buhlmann.de

■ **Finland** Salomonkatu 17 B 141, 00100 Helsinki, Finland  
Tel.: +358 9 439113-0, Fax: +358 9 43911313  
finland@buhlmann.de

■ **Great Britain** Unit 3B Newton Court, Pendeford Office Park  
Wobaston Road, Wolverhampton WV9 5HB, Great Britain  
Tel.: +44 1902 781300, Fax: +44 1902 781301  
greatbritain@buhlmann.de

■ **France** – BUHLMANN France S.A.S.  
Espace Saint Christophe, 1 Avenue des Beguines  
95800 Cergy Saint Christophe, France  
Tel.: +33 1 342017-20, Fax: +33 1 34201721  
france@buhlmann.de

■ **Netherlands** Ohmweg 1b, 2952 BD Alblasserdam, Netherlands  
Telefon: +31 78 69913-88, Fax: +31 78 6991399  
netherlands@buhlmann.de

■ **Austria** Bleckmangasse 10, 8680 Müritzschlag, Austria  
Tel.: +43 3852 5511-00, Fax: +43 3852 551102  
austria@buhlmann.de

■ **Italy** Via G. Paglia 30, 24122 Bergamo (BG), Italy  
Tel.: +39 035 0779148, Fax: +39 035 0779180  
italy@buhlmann.de

■ **PR China** – BUHLMANN Delegate, c/o C. Melchers GmbH & Co.  
Room 503-504 Beijing Tower, No. 10, Chang An Ave. (East)  
Beijing 100006, PR China  
Tel.: +86 10 65257775, Fax: +86 10 65123505  
buhlmann@bj.melchers.com.cn

■ **PR China** – BUHLMANN Delegate, c/o C. Melchers GmbH & Co.  
13th Floor, East Ocean Centre, 588 Yan-An Road (East)  
Shanghai 200001, PR China  
Tel.: +86 21 63528848, Fax: +86 21 63513138  
buhlmann@sh.melchers.com.cn

■ **Thailand** – Representative Office  
15th Floor Sorachai Building, 23/31-39 Sukhumvit 63  
Klongton-Nua, Watthana, Bangkok 10110, Thailand  
Tel.: +66 2 7143-105, Fax: +66 2 7143106  
thailand@buhlmann.de

■ **Singapore** – BUHLMANN Singapore Pte Ltd.  
Singapore, Tel.: +65 9819 4291, Fax: +65 6441 4122  
singapore@buhlmann.de

1 **DIN Boiler Tubes**  
DIN Kesselrohre

2 **DIN Fittings**  
DIN Fittings

3 **ASTM Pipes**  
ASTM Rohre

4 **ASTM Fittings**  
ASTM Fittings

5 **Seamless / Welded Stainless Steel Tubes and Pipes**  
Nahtlose / Geschweißte Edelstahlrohre

6 **Stainless Steel Fittings / Flanges to ASTM and DIN**  
Edelstahl Fittings / Flansche nach ASTM und DIN

7 **Carbon / Alloy Steel Flanges to ASTM and DIN**  
C-Stahl / Legierte Flansche nach ASTM und DIN

[www.buhlmann.de](http://www.buhlmann.de)